



Hampshire Field Club & Archaeological Society

Newsletter

No 58, Autumn 2012



Photograph of a runner coming through Nether Wallop with the Olympic torch in 1948 (HRO 141M83/131).

Archaeology



Historic Buildings



Landscape



Local History



Contents Autumn 2012

General editor, Dick Selwood

From the President (*Dick Selwood*)

President's notes	Dick Selwood	1
Local History (<i>Section editor, Mark Page</i>)		
James Richards of Overton 1892 to 1916: Congregational Pastor and Local Politician Part 2	Roger Ottewill	2
A Dispute over Tithes in Binsted	Major R G Reed, ed. Jane Hurst	5
Archives and Local Studies News from Hampshire Record Office	David Rymill	6
Book Reviews		10
Historic Buildings (<i>Section editor, Edward Roberts</i>)		
Visit to Bishop's Waltham Palace	David Whiter	11
A Wall Painting at the Church of St Andrew, Timsbury, Hampshire.	Roger Harris	11
An early Cruck House at No 1 Somerset's Cottages, Bentley, Hampshire.	Bill Fergie	13
The Former Anchor Public House, London Street, Basingstoke	Bill Fergie	17
Archaeology (<i>Section editor, David Allen</i>)		
Editorial	David Allen	18
Quarley Down Ancient Environs Project	David Allen	20
Landscape (<i>Section editor, George Campbell</i>)		
Editorial	George Campbell	21
William of Wykeham's Contribution to the Educational Landscape	George Campbell	21
Tankerville Chamberlayne's Part in Eastleigh's Late Industrial Development		23
A Drover's Legacy	Malcolm Walford	26

ISSN 0265-9190

Registered Charity No 243773

The Society acknowledges the support of Hampshire County Council

From the President

Dick Selwood, 34 North View, Winchester, SO22 5EH
Email: president@fieldclub.hants.org.uk

Winchester Writers' Conference

For some years now, the Field Club has sponsored one of the competitions associated with the annual Winchester Writers' Conference. The rules are that competitors submit well documented and referenced manuscripts describing any aspect of local history in Hampshire, which may include photographs, sketches, maps and other illustrations. There is a minimum of 1000 words and a maximum of 10,000 words.



Dr Mark Allen from Winchester University's Department of History was this year's adjudicator, and I attended the awards ceremony with Mark, to award the prizes. For the record, the winners were:

- 1st (with a prize of £250 and the Margaret Kryle Trophy) was Brenda Fruen – *Cannon Court, Kingsclere: A Study of the Agricultural Revolution and Landownership on the 18th Century Chalklands.*
 - 2nd (with a prize of £75) Dr A.E Gallon – *An Eighteenth Century Credit Crunch (The financial troubles of Thomas Jervoise (1667-1743) of Herriard).*
 - 3rd (With a prize of £50) Chris Corcoran – *Twyford's Historic Landscape: the five mills of Twyford in 1300.*
- Highly commended was Michael Southgate – *Youthful Offenders: a history of Hampshire Reformatory Schools for Boys, 1855-1908.*



There were 18 competition classes, some with multiple winners, so the ceremony went on for quite a while. Just to make the time seem even longer, unlike many of the better known ceremonies such as the Oscars, the ceremony was before the conference dinner. It was exciting to be even a very minor part of such an important event, attracting a wide breadth of backgrounds of conference attendees and the prize winners.

Secretary

Alex Lewis, who has been a stalwart secretary, has stepped down from the role. Although she is now based in Cornwall, she will regularly be back in Hampshire and hopes to attend meetings. I want to offer Alex my personal thanks to that of the Council for the tremendous help she has given the Field Club.

Fortunately, Chris Sellen has agreed to take over the role, subject to formal co-option by Council and later to election at the AGM. Chris is active in the Archaeology section, and was already an ordinary member of council. He is following courses in archaeology and history, is a private pilot and his day job is in IT, currently working on the merger of Test Valley and Winchester City IT services.

Ordinary members

By the constitution, Council is made up of elected officers, representatives of sections and ordinary members. We have vacancies for ordinary members, so if you would like to help keep the Field Club alive and are able to attend three meetings a year, usually on a Wednesday evening, please get in touch with Chris. His details are on the membership card enclosed with this newsletter and on the Field Club web site.

Hampshire Studies

Later in August you will be receiving an extra issue of Hampshire Studies (Proceedings). There has been a build-up of reports from commercial archaeological companies, who pay a publishing charge to the Field Club. This backlog had reached the stage where it was possible to devote an entire issue to these reports, and still have enough material for a normal mix of topics at the normal time in December.

Winchester Excavation Committee

Staying with archaeology, it is 50 years since Martin Biddle created the Winchester Excavations Committee. To mark this anniversary, the committee has been fundraising for a final push at completing the publishing of the Winchester Studies.

The Committee has just published The Winchester Mint volume (Volume 8). It catalogues and illustrates the minting of silver pennies in Winchester between the reigns of Alfred the Great and Henry III, a period of three



and a half centuries. At the Mint, which was situated in the area of the High Street to the east of where the city's cross now stands, at least 24 million silver pennies (possibly as many as 50 million) were struck. The five and a half thousand that survive in museums and collections all over the world have been catalogued by Yvonne Harvey., and photographs of both sides of some 3,200 coins forms the core of Part I. Part II moves from the Mint to present more than two hundred coins, jettons, tokens, and seals found in the excavations of 1961-71, including a ninth-century Kufic coin from Samarkand, Byzantine coins and seals, and a Hebrew token.

Events

The autumn sees some exciting full day events from Local History (visit to Lyndhurst on 6th October), Landscape (day conference on Waterways in the Landscape on 27th October) and Archaeology (day conference on The Changing face of Kingship in Early Medieval England on 24th November). Historic Buildings have what sounds like a stunning talk "How to Take a House Down" by Richard Harris, the former Director of the Weald and Downland Museum.

© Trustees of the British Museum.
The first coins to bear the name Winchester (abbreviated to PIN as seen here, where the 'P' is the Anglo-Saxon letter for 'W'), struck by King Alfred in the 880s or 890s.

Local History

Editor: Mark Page, 7 Irwell Close, Oakham, Rutland, LE15 6SX
email: mrp15@leicester.ac.uk

James Richards of Overton 1892 to 1916: Congregational Pastor and Local Politician

Roger Ottewill

Part 2: 'A Workman Who Needeth Not Be Ashamed'

In the first part of this article, consideration was given to the early life of James Richards and the first 10 years of his ministry in Overton.¹ By 1902 he and his wife had already made an impressive contribution to the Congregational Church and judging by press reports they were well respected by everyone in the community. Building on these foundations, the next decade was to prove to be even more fruitful, notwithstanding setbacks on the political front in 1904.

With respect to the relationship between Richards' role as a Congregational pastor and as a public representative there was an element of reciprocity. In exercising his pastoral responsibilities, Richards would have been made aware of problems and issues that required action on the part of public authorities. While at the same time, being a parish councillor and one of Overton's representatives on Whitchurch Rural District Council and Board of Guardians [RDC/BG] helped to keep him in the public eye and may well have encouraged some to attend his Church.

It is noteworthy that reference was made to the secular aspect of Richards' work and witness in the reports that the Church was required to submit to the Hampshire Congregational Union [HCU] as a condition of receiving financial support:

[Mr Richards] well sustains the best traditions of nonconformity in his work as a citizen on the Parish and Rural District Councils.²

Mr. Richards stands strenuously for our Free Church principles in the life of the village, his work and character have won the respect of all, and for a second time he has been returned at the head of the poll for the Rural District Council.³

However, his evident popularity in the public domain proved to be something of a mixed blessing during the controversy which arose over the Education Act 1902.

The Education Act 1902 Controversy

In seeking to reform the arrangements for elementary education, the Unionist Government secured the passage of legislation in 1902 that was particularly contentious, especially with Nonconformists. Their sensibilities were upset because the Act was seen as privileging Church of England schools by giving them access to funding from the rates, with county and county borough councils being designated local education authorities.⁴ Moreover, in their schools Anglicans were still able to determine the content and character of the religious instruction given to pupils and to maintain staffing policies which were seen as being biased against Nonconformists. This triggered one of the most overtly partisan stands of Richards' career as a local politician. His antipathy

towards the legislation was expressed in no uncertain terms at his eleventh anniversary celebration in 1903:

They were sorry for the recent Education Act that was now to be carried out, for members of the House of Commons should not be one-sided, and this law was one-sided which said that the children of half the people in the country [i.e. Nonconformists] might be pupil teachers but they must not be head teachers, though all were to pay equally the rates to keep the schools going. His opinion was that the head teachers should be selected from those who were most worthy and not on account of any creed they professed.⁵

A few months later, Richards chaired the opening meeting of the campaign against the Act in the Whitchurch area and 'reminded the audience of the persecution that their fathers had had to put up with in

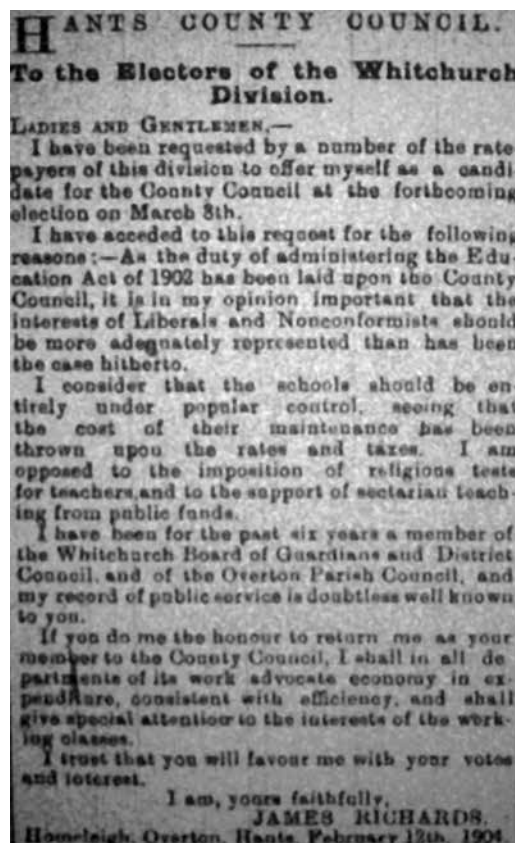

Fig 1 James Richards's address for the 1904 county council election.

the past ... As the father of six boys and six girls he had a great love for children, and he was willing to suffer any persecution to free the schools from denominational teaching'.⁶ One element in their strategy of opposition was for Nonconformists to refuse to pay that part of their rates which they considered would be used to

subsidise Church of England schools. By engaging in what was known as passive resistance, they were responding to an acute sense of injustice and a firm belief that right was on their side, even if it meant having goods seized by the bailiffs because they had not paid their rates in full.

It was also decided to put up a Free Church candidate for the Whitchurch seat on Hampshire County Council in the elections which were due in March 1904.⁷ With his crusading zeal, high profile and political experience it was not really surprising that Richards was persuaded to be the standard bearer for the Nonconformist cause in this contest. His motivation for standing was spelt out in an election address published in the *Hants and Berks Gazette* (Fig. 1).

At an election meeting held at Overton in support of Richards' candidature much was made of the under-representation of Nonconformists on the county council. The meeting was chaired by W.G. Anderson, Whitchurch's Baptist minister and a close ally of Richards. He drew attention to the fact that pressure from the local Free Church Council was required to secure greater representation of Nonconformists on the local sub-committee established by Hampshire County Council to facilitate the administration of the new legislation. Moreover, in his view 'it would have seemed advisable to put some parents of children ... [on this body], but instead the aristocrats of the district had been chosen'. Thus, the issue of social class was clearly in evidence, with Richards being promoted as a 'man of the people'. While it was acknowledged that, on the whole, the county council was implementing the Act in an equitable manner, as Richards put it: 'the Act was wrong and the carrying out of a wrong thing fairly could not make it right'.⁸

In the election contest, however, Richards faced stiff competition from his opponent William Portal, who had been the incumbent since 1889, the year in which the county council was established. In addition, as owner of the local paper mill he was an extremely well known and well respected figure in the locality. Although Richards 'bore no ill feeling towards the present County councillor, who had always acted in a kind and gentlemanly way', there was some concern over his behaviour towards passive resisters when they were brought before the court. It was pointed out that in his capacity as chairman of the magistrates Portal 'would not allow defendants to state their conscientious objections'.⁹ This was seen as an attack on free speech.

At an election meeting in Overton in support of Portal's candidature it is not surprising that the candidate dealt 'at some length with the Education Act and its working in ... [the] county'. In defending how the county council had exercised its responsibilities, particularly with regard to the religious aspects, he pointed out that 'not only were all denominations apparently satisfied with what had been done, but other county councils had inquired as to their procedure with the view of deliberating upon it'.¹⁰ This was a reference to the scheme for religious instruction in Hampshire County Council schools, which was, indeed, regarded as a model of its kind. However, the scheme did not necessarily apply to Church of England schools.

One immediate consequence of Richards' temerity in taking on Portal was the outcome of the parish council election which was held on the eve of

the county council contest. At the parish meeting 'considerable interest was shown compared with what ... [had] of late years been the case, no doubt owing to the more stirring contest in connection with the County Council, which had awakened the fighting spirit of the electorate'.¹¹ That said, this show of interest was not to Richards' advantage and of the 16 candidates he suffered the ignominy of coming last with a miserly six votes. By comparison the most successful candidate, the vicar of Overton, Canon George Stenning, secured 54 votes.

The parish council result was to prove a portent for the outcome of the county council contest. If Richards could not hold his parish council seat it was very unlikely that he would perform well across the much broader Whitchurch division. In the event he was trounced, securing just 230 votes against the 599 amassed by Portal.¹²

In the circumstances, Richards probably feared the worst for the next electoral contest at the end of the month. This was for his seat on Whitchurch RDC/BG. However, not only did he retain his seat but he finished top of the poll. Possible explanations for this turnaround in his electoral fortunes include the probability that the electors felt he had been punished enough. Moreover, he had an established reputation as a competent district councillor and guardian. In the longer term his advocacy of the Nonconformist cause in the controversy surrounding the Education Act 1902 does not appear to have damaged his standing in the community and although he never sought to regain membership of the parish council he continued to represent Overton on the RDC/BG until early 1917.

Leading the Congregational Church

Notwithstanding Richards' vicissitudes on the political front, the Congregational Church continued to flourish. Tributes to his leadership skills and fortitude were regular features of anniversary meetings, with favourable contrasts being drawn between the situation before and after his arrival. In 1904 these were coupled with an appeal to 'young people to join the church and take their stand against evil'.¹³ This seems to have met with some success judging by later references to Overton Congregational Church being a young people's church.

Richards himself, speaking in a somewhat self-congratulatory manner at the 1906 autumnal meeting of the HCU, observed that:

*Fourteen years ago they had 35 of a congregation, now they had 140 (applause). The congregation had thus been steadily increasing, and this year it was larger than ever. If they had come to his church last Sunday they would have seen one side of his chapel filled with young men. Last year they raised £85, and £32 of that sum went towards repairs.*¹⁴

Thus, in both numerical and financial terms the Congregational cause in Overton was flourishing.

There is also evidence to show that Richards' reputation was such that by now he had become known well beyond Hampshire. For example, in 1907 he was invited to address the delegates at a meeting of the Congregational Union of England and Wales in Southport. As it was put in the local newspaper, this was 'a considerable honour to Congregationalism' in the district as Richards was by this time pastor of both

Overton and Whitchurch Congregational Churches.¹⁵ He had taken over pastoral responsibility for the cause at Whitchurch in early 1906, but by his own admission he found it 'uphill work'.¹⁶ That said, the cause was maintained and the finances were such that after 1906 it no longer required financial assistance from the HCU.

A further example of Richards' standing in the wider world comes from 1909 when he preached at the prestigious Westminster Chapel in London, with the *Andover Advertiser* quoting at length from *The British Congregationalist*:

*This year the simple story of Mr Richards, an evangelist from Hampshire, won every heart ... [he] gave some account of his work at Overton. If it was not for the country ... the city would starve in weeks. The country was very generous, it was continually pouring its supplies into the city. They wanted the city to be generous to the country. The influence of the country extended to the ends of the earth; there was no limit to the power of the living gospel ... They did not trouble the villagers with the New Theology or the Old Theology, but they did preach the power of the living Christ and a salvation for this life and the life to come.*¹⁷

Notwithstanding its slightly patronising tone, Richards was clearly viewed as a powerful advocate for the cause of rural Congregationalism.

The size of the Overton congregation continued to increase and by 1909 the Church was reporting average attendances of 196.¹⁸ In 1910 Richards' popularity was again highlighted at the 18th anniversary of his settlement. As reported:

*Mr Richards has endeared himself to a large number of Overton parishioners, in fact it would be safe to say that all recognise in him one who has striven hard at all times to place duty first, never sparing himself in furthering the welfare of his congregation, and being ever ready to help others in his public capacity as a member of the Whitchurch Board of Guardians.*¹⁹

In the same year he received full ordination at the spring meeting of the HCU held in Southampton, in recognition of his loyal service and effective ministry. Up to this point, he had remained an evangelist and ordination was a considerable accolade.

Explaining his Success

The question arises as to what, in human terms, accounts for the success of Richards' ministry in Overton. It would seem that there were a number of factors at work.

First, there was his untiring energy and force of personality and the substantial support he received from his wife. Notwithstanding his age, it is clear that he retained his enthusiasm and ability as a preacher and was in every sense a driven man. Alfred Capes Tarbolton, the respected pastor of London Street Congregational Church in Basingstoke, commented at Richards' 14th anniversary celebration in 1906, that he was 'a workman who needed not be ashamed. He was efficient in the practical part of Christianity'.²⁰

Second, in an attempt to appeal to as broad a section of the community as possible, he was happy to experiment with many different modes of worship, including open air services, lantern (slide) services, services of song and a spring flower service. In 1907 open air services were replaced by 'Sunday afternoon meetings in the Chapel after the style of a PSA [Pleasant

Sunday Afternoon]'.²¹ In short, they were 'Bright, Brief & Brotherly'.²² At it was put in the *Hants and Berks Gazette*, Richards was the 'most inventive of ministers in the inception and carrying out of new features in the work of his church'.²³

These initiatives alongside the regular services and those for special occasions, such as harvest, appear to have been very popular. Moreover, as indicated earlier, Richards' ministry achieved considerable success with one group that was notoriously difficult to reach, namely the young and, in particular, young men. Thus in its report to the HCU for 1906 it was confirmed that, 'the Church had kept up its reputation as a Young People's Church during the year, frequently there are 35 young men, excluding those who are Church Members, present at the Evening service; the Services of Song and the Working parties have maintained the interest of the young people of the Church'.²⁴ The nature and role of the working parties is not known, but clearly the Church under Richards' leadership had found an effective means of securing the interest of young people. Four years later it was reported that the Church continued 'to attract large numbers of young men and women'.²⁵

Third, Richards also appears to have had advanced views on women leading worship and preaching, when this was a rare occurrence even in Congregational churches. There are a number of reports of women occupying the Overton pulpit. In 1902, for example, Miss Tull, who had been conducting a mission in Overton, 'preached morning and evening to large congregations',²⁶ and in 1908 Mrs Sydney Watson 'preached morning and evening to packed congregations, her glowing eloquence being much appreciated'.²⁷ Richards' willingness to facilitate the ministry of women can be explained, in part, by the fact that one of his daughters, Annie Williams, preached to good effect from time to time at Overton and Whitchurch.

Fourth, Richards was clearly able to inspire others and had an excellent rapport with his deacons. He also built up a committed team of workers to promote different facets of church life. One of these



Fig 2 Sunday school anniversary celebration. Photo courtesy of Tony Morris.

was the Sunday school which as the photograph of the anniversary celebrations in 1907 illustrates was thriving (Fig. 2). Other organisations for children and young people were branches of Christian Endeavour; the Band of Hope, which promoted the cause of temperance; and a juvenile sewing class started by Mrs Richards. She also played an important part in arranging meetings specifically for women and in contributing to the pastoral work of the Church.

A final factor was Richards' popularity within the community at large which undoubtedly helped to keep the Congregational Church in the public eye. He was also ecumenically minded, not only in respect of the warm relations he enjoyed with fellow Nonconformists but also in his dealings with Anglicans, notwithstanding their differences over the Education Act 1902. Indeed, in 1903 Richards commented at his anniversary celebration that 'he did believe he had the esteem of members of the episcopal church, for he had always tried, though they might differ in religious and perhaps political matters, to keep their opinions but still be good friends'. This elicited a 'hear hear' and he went to say that 'he rejoiced at all the good work that was being done by the Episcopalian church'.²⁸ It is possible that this generosity of spirit was fostered, at least in part, by the fact that between 1899 and 1910, Canon George Stenning served alongside Richards as one of the parish's three representatives on Whitchurch RDC/BG. As an example of their shared concerns the following exchanges took place at a meeting in April 1902:

Canon Stenning: There are a number of cottages in Overton unfit for human habitation

Rev H.D. Lewis [Vicar of St Mary Bourne]: It raises the whole question of whether the Council should take advantage of the Labourer's Cottages Act. Some of the houses in the rural districts are as bad and as overcrowded as any of the London slums.

*Rev J. Richards: Yes, I could take you to a cottage, with only one bedroom and one room downstairs, where a man and wife and five children sleep, and some of the children are getting big too.*²⁹

Making common cause on social issues undoubtedly helped mitigate any differences on educational matters.

Whatever the secret of his success, it was undoubtedly the case that Overton and Richards were made for each other. His personality was clearly in tune with the prevailing spirit of the village and his

evangelistic background enabled him to communicate the Gospel with confidence and in ways that resonated with many in the community. The result was both a thriving church and a considerable amount of mutual respect.

Notes

- 1 Roger Ottewill, 'James Richards of Overton 1892 to 1916: Congregational Pastor and Local Politician. Part 1: "Beloved by all members of the community"', *HFC Newsletter* 57 (Spring 2011), pp.17-19.
- 2 HRO 127/M94/62/47, Annual Report of Hampshire Congregational Union [HCU] for 1902, p.23.
- 3 HRO 127/M94/62/48, Annual Report of HCU for 1903, p.21.
- 4 For further details see Roger Ottewill, "'Education, education, education': researching the 1902 Education Act', *The Local Historian* 37 no.4 (2007), pp.258-72.
- 5 *Andover Advertiser*, 22 May 1903.
- 6 *Hants and Berks Gazette*, 17 Oct. 1903.
- 7 The Whitchurch electoral division included Overton.
- 8 *Romsey Advertiser*, 4 Mar. 1904.
- 9 *Romsey Advertiser*, 4 Mar. 1904.
- 10 *Romsey Advertiser*, 4 Mar. 1904.
- 11 *Hants and Berks Gazette*, 12 Mar. 1904.
- 12 For full details of this and other results see Roger Ottewill, 'Hampshire and Surrey County Council Elections 1889-1974', *Wessex Historical Databases 4*, Wessex Centre for History & Archaeology (2010), CD.
- 13 *Andover Advertiser*, 20 May 1904.
- 14 *Romsey Advertiser*, 3 Nov. 1906.
- 15 *Andover Advertiser*, 22 Mar. 1907.
- 16 HRO 127/M94/62/51, Annual Report of HCU for 1906, p.27.
- 17 *Andover Advertiser*, 28 May 1909.
- 18 HRO 127/M94/62/54, Annual Report of HCU for 1909, p.24.
- 19 *Hants and Berks Gazette*, 7 May 1910.
- 20 *Andover Advertiser*, 11 May 1906.
- 21 HRO 127/M94/62/52, Annual Report of HCU for 1907, pp.26-7.
- 22 HRO 159/M85/1, Overton Congregational Church minute bk, 2 Sept. 1907.
- 23 *Hants and Berks Gazette*, 19 Apr. 1902.
- 24 HRO 127/M94/62/51, Annual Report of HCU for 1906, p.27.
- 25 HRO 127/M94/62/55, Annual Report of HCU for 1910, p.28.
- 26 *Hants and Berks Gazette*, 6 Dec. 1902.
- 27 *Andover Advertiser*, 27 Nov. 1908.
- 28 *Andover Advertiser*, 22 May 1903.
- 29 *Hants and Berks Gazette*, 12 Apr. 1902.

A Dispute over Tithes in Binsted

Major R G Reed, ed. Jane Hurst

This article comes from an unpublished History of Binsted by Major R G Reed, the text of which is held at the Curtis Museum in Alton. The source of the information appears to be a small book with 'Mas' Hy Wheeler 1821' written inside it which is part of the Wheeler collection in Hampshire Record Office.¹ Henry was probably the son of Henry and Jane Wheeler who was baptized in Binsted on 5 January 1813, making him aged about 8 years old in 1821. He (or someone else) seem to have used the book to copy out various old Binsted parish documents: perhaps as a writing exercise?

In the article below, Major Reed was, unfortunately, mistaken about Dr Samuel Woodford being appointed Vicar of Alton,² but the article throws an interesting light on some of the problems that were associated with the payment of tithes. Dr Woodford had legal training before he was ordained and he then went on to be presented to the livings of Shalden and Hartley Mauditt³ as well as becoming a prebendary of

Chichester and of Winchester. He was also related to the Parson Woodforde who wrote The Diary of a Country Parson.

Tithes are generally defined as 'the tenth part of fruits and profits justly acquired, owed to God in recognition of his supreme dominion', and were paid to the parish priest either in cash or in kind. They had been a constant source of contention ever since their enforcement in the 10th century, and it is therefore not surprising to find Dr Samuel Woodford in 1669, shortly before he became vicar of Alton,⁴ obtaining the agreement of the parishioners of Binsted to the scale of tithes to be paid to him as soon as he was inducted:⁵

'For the Fall of every Calf One Shilling, For the White of every Cow⁶ One Shilling, For every Fattening Beast put to Fattening at or before the First day of June, and also such as shall Foot any Beast afterwards and make no First return shall for every such Beast pay

One Shilling, For the Fall of every Colt One Shilling, For every Tythe Pig One Shilling, For every Tythe Goose One Shilling, For every Tythe Turkey One Shilling, Hops, Bees, Coppice, Frith, Garden Beans, Fish, Pares, Walnuts and all other Small Tythe to be pay'd in kind'.

This arrangement was clearly acceptable to the 149 people who signed the document,⁷ but not so with Mr Grimshaw Smith, who on being appointed vicar [of Alton and its chapelries] in 1741, immediately raised the tithes, and then two years later threatened the inhabitants of Binsted with court action when they failed (or refused) to pay. The people then asked for a meeting with him to discuss the matter and so avoid being taken to court, but when that failed,⁸ the parishioners drew up a document affirming their solidarity in the face of his offensive: 'Whereas the Reverend Mr Smith, Vicar of the Town and Parishes of Alton, Binsted and Kingsley⁹ seems to impose upon us the parishioners of Binsted touching our small and Privy Dues... We the parishioners of Binsted who have hereunto set our hands do resolve and firmly agree to stand by each other that shall be sued or prosecuted for his small or Privy Dues contrary to Ancient Customs, which is twelve pence for the Fall of a Calf' etc. repeating, in slightly different words, the rates agreed with Dr Woodford 72 years earlier. There is no record of the issue being judged at the County Quarter Sessions, so presumably Mr Grimshaw Smith was able to make his peace with his parishioners, and come to an acceptable scale of tithe payments.

One hundred years later, in 1836, an Act was passed abolishing this method of paying tithes and ordering that rents were to be levied in its place. Thomas James Tatham was appointed Assistant Tithe Commissioner 'to ascertain and award the sums to be paid by way of Rent Charges instead of Tithes in the Parish of Binsted', and Charles Osborne of Fareham and William Keen of Godalming were appointed to value all the property in the parish. This was done with meticulous accuracy and resulted in the production, in 1843, of a finely detailed tithe map of the parish¹⁰ (one of the largest prepared in Hampshire), and a schedule of tithes to be paid by all property owners.¹¹

The Dean and Chapter of Winchester Cathedral were, as might be expected, the appropriators of most of the tithes in the parish, but the Neatham tithery was held half by the 'Trustees of the Algebra Lectures by Dame Mary Sadlier in the University of Cambridge', who received a rent of £70 p.a. for their 481-a. holding,

and half by James Langrish and Daniel Inwood, who received £66 16s. for the remainder. The Dean and Chapter had leased their great tithes to Richard Warner of Lofton in Devon and Charlotte Ashe of Bath, so these two persons received the bulk of the award, amounting to £761 2s. 3d. p.a. The vicar of Alton was entitled to the small tithes, which amounted to £345 11s. 1d., though whether he found this any easier to collect than the revenue from every tenth turkey etc. we shall never know.

Even this form of tithe payment lasted little more than 50 years, for in 1886 an Act was passed whereby all owners of property could redeem their tithes by paying the capital value of land, equivalent to 25 years rent. These redemptions were not all paid at once, and indeed it was another 50 years before they were paid in full, enabling the Board of Agriculture to issue the final certificate to the effect that the 'said Rentcharge is redeemed and the lands described ... are hereby absolutely freed ... from the said Rentcharge'. And so in 1936 the arguments about tithes were finally brought to an end, though in the meantime another dispute had arisen between the parishioners and the vicar of Alton, this time over the parsonage house at Binsted.

Notes

- 1 Hampshire Record Office (HRO) 3M51/566.
- 2 A Thomson, *The Clergy of Winchester, England, 1615-1698* (2011) lists the vicars of Alton for this period as Henry Butler and Thomas Matthew.
- 3 Thomson, *Clergy of Winchester*, gives Samuel's dates as 1672-1701 in Hartley Mauditt and 1673-1701 in Shalden.
- 4 There seems to have been a general misunderstanding; Dr Woodford never became vicar of Alton. According to www.theclergydatabase, he was appointed curate of Binsted (which was a chapelry of Alton) in 1670. The source given is HRO 21M65/B1/39.
- 5 'A Composition made between Mr Sam^l Woodford and the Parishioners of the Parish of Binsted for Dues from Michaelmas Last, agreed upon this third Day of December 1669 During the time that he shall be Minister here'.
- 6 A cow in milk.
- 7 Eight people did not sign.
- 8 HRO 3M51/566: 'Reverend Sir, We are sorry that you would not please to meet us this day that we might know upon what terms you were resolved to have your small and Privy tythes but we hope that you will be pleased to do it before you Prosecute any of Us for we are willing too pay according unto our Antient way of Payment and we are willing if you desire it to meet you before our Superiors in order that we may be Settled by them if we are Wrong or if you are minded to give us trouble in the Courts above give us but time to be Advised and we will either Pay it in kind or else Joyne Issue with you and try it as Soon as we can'.
- 9 Holybourne was also a chapelry of Alton.
- 10 HRO 21M65/F7/20/2, Binsted tithe map.
- 11 HRO 21M65/F7/20/1, Binsted tithe award.

Archives and Local Studies News from Hampshire Record Office

David Rymill

Recent additions to the archives

Smartest styles in the district

The latest deposits of Anglican parish records include a number of Wellow parish magazines between 1895 and 1939 (14M75/PZ7). Although they usually consist of only four pages, they include the names of many parishioners, such as those who gave donations for the reading room and the soup kitchen in 1897, or to the cricket club in 1900. The advertisements are also interesting: in 1906 Elcombe and Son of Romsey

'respectfully announce that their Seeds are now ready for the garden and farm... They have spared no expense to obtain the finest Stocks of all varieties, and will not be undersold by any respectable House in the Kingdom', whilst Sharland's of Romsey describe themselves as 'The up-to-Date Firm for blankets, sheetings, calicoes, &c', offering 'Smartest Styles in the District and Lowest Charges'.

In Netley cemetery

We have received two registers of graves at Netley military cemetery for 1864-1975 (77A11). As they are very fragile, we are making them available digitally on a CD (CD29, on open access in the search room). There are Church of England, Roman Catholic, Presbyterian and Methodist sections, and entries for American troops and prisoners of war.

Digital accessions

The latest digital accessions include copies of recent Winchester Citizens' Advice Bureau annual reports (17M86W), and illustrations of St John's Church, West Meon, before, during and after the building of the new church in 1846, and of successive 19th and 20th-century rectors (67M81). We've also received, from the Hyde900 project and from Basingstoke, synopses and transcriptions of oral history recordings; the recordings are in Wessex Film and Sound Archive.

Apprentices and almspeople

The archive we hold on behalf of the Andover Charities now includes the trustees' minute book for 1892-1982 (98A08/7/1). Those pages dating from before 1911 may be freely consulted and they refer to a number of local boys who were helped to become apprentices. In an age before pensions, elderly people would count themselves fortunate if they were able to secure a place in an almshouse: an account book relating to money paid to inhabitants of the almshouses adjoining Odiham churchyard (84A11/1) was recently passed to us by the Odiham Society. John Gale died in 1829 leaving instructions that the interest arising from a sum of £1,500 was to be paid to the 10 inhabitants of the almshouses, and the book records their names from 1830 to 1846.

Pubs and clubs

One of the largest recent deposits came from the Courts Service, and includes records of Petty Sessions (magistrates' courts). Court registers over 100 years old are available for consultation, as are registers of licences, which are a useful source for the history of publichouses. These records include: Basingstoke: court registers, 1880-99, and registers of clubs and licences, 1903-53, for the Borough (77M82); licensing registers, 1872-1962, for the surrounding Petty Sessional Division, i.e. nearby villages (97M83); Andover: registers of clubs from 1932 and licences from 1903, for the Borough (163A11); court registers, 1882 onwards, and registers of clubs, 1910-62, and licences, 1879-1969, for the sessional division (129M94); Kingsclere: licensing and club registers, 1903 onwards (46M67).

The registers of clubs give interesting insights into how Hampshire people have spent leisure time, as in many cases copies of the clubs' rule books have been pinned into the volumes. For instance, the register for Andover Borough for 1956-62 (163A11/XP39) includes copies of the rules of the British Rail Southern Region Staff Association (Andover Branch) and the Wolverdene Club (for veterans of the 1st Battalion the Hampshire Home Guard, the Southern Railway and GPO (Andover) Platoons of the Home Guard, etc).

The earliest of these records are three court minute books from the Petersfield area, 1842-64 (21M73/XP185-187), a particularly pleasant surprise as we hold very few records of the mid 19th-century Petty Sessions for the county's rural divisions. They include defendants accused of offences ranging from assaults to 'throwing off fireworks'. Many were charged with poaching or

the theft of timber, which gives an indication of the desperation to find food or fuel. A 'deposition book' recording witness statements in court at Petersfield in 1870-1 (21M73/XP188) is a rare survival, letting us hear more directly what was said in court.

Following in their footsteps

We are always pleased to receive copies of work already done by local historians, which may help future researchers. We have received a set of notes by Judith Patrick about Hampshire houses which were certainly or possibly designed or altered by the architect Walter Frederick Cave (1863-1939), including Ditcham Park and Buckmore in the Petersfield area; Tile Barn at Woolton Hill near Highclere; St Austin's, Lymington (once the home of John Howlett, founder of the local firm Wellworthy, and subsequently largely demolished); and Roche Court (now Boundary Oak Preparatory School) and Blackbrook Grove (a cottage orné once used as the Bishop of Portsmouth's house), both in Fareham.

In the late 1950s and early 1960s the place-name scholar J E Gover corresponded with the local historian Arthur Lloyd about place names in the New Forest, and Gover's letters have now been placed with us (59A10/1). As the English Place Names Society has not yet covered Hampshire, Gover's typescript notes on Hampshire names are in regular use in the search room, and these letters are a useful complement to them. He discusses features including the occurrence of Norse personal names such as Thorkil in Thruxton ('Thurkilleston' in 1202), and names warped by folk etymology such as Foxlease, 'Cokkesleys', c.1490.

Maps and mills

Maps can give a vivid impression of our communities in past centuries. A newly received map of Carpenter's Farm, Whitsbury, on the Hampshire/Wiltshire border, dated 1805, shows the farm buildings on the east side of the road from Salisbury to Fordingbridge, to the west of Whitsbury Church, with an orchard and fields nearby (71A11/1).

Among recent acquisitions of business records is the archive of T A Aylward & Sons of Dunbridge Mills (34A11). By the 1880s Thomas Alfred Aylward was employing eight men and two boys; he had mills at Lockerley, Dunbridge and Kimbridge. The archive primarily consists of accounting records such as customer ledgers, sales books and day books, mainly 1920s-60s, and also includes a wages book dated 1906-7.

A jubilee and a coronation

A collection of recently-donated Durley parish magazines covering 1897-2009 (21A12, not complete) includes a description of the Durley schoolchildren's outing to mark George V's Silver Jubilee in 1935. The report by one of the children, Una Thomas, describes them being ferried to Botley station in char-à-bancs, taking the train to Portsmouth, and lunching on the sands at Ryde.

An interesting collection of records of Durley School (18A12) includes a series of log books from 1863 to recent times. The volume covering 1953 (18A12/LB4) records local celebrations for the Queen's Coronation in 1953: on Coronation day, 2 June, a tea, sports, bonfire and fireworks were held; on the following day the Junior School children took part in a pageant in the Memorial Hall, and on 27 June six girls and six boys danced at the County 'Come & Dance Festival', 'the

boys being dressed in white, & half the girls in red & half in blue'.

The minute books for Martin Parish Council, 1894-2004 (37A12) show that concerns in the 1890s included footpath repairs, horses and wagons being taken onto the village green, and the provision of allotments. Martin parish also saw Jubilee celebrations in 1935, and the minutes include a detailed schedule listing many of those who took part, including Mr C Percy and his team who rang the church bells at 10.30am, and Mr W M Lush who led the committee and provided a field for sports.

Local studies books recently added to the shelves

Land and Family by John Mullan and Richard Britnell looks at trends and variations in the peasant land market on the Winchester bishopric estates, 1263-1415, using the Winchester Pipe Rolls.

Lady Almina and the Real Downton Abbey: the present (8th) Countess of Carnarvon tells the story of the 5th Countess and the hospital she ran at Highclere Castle during the First World War.

Two books on Hampshire folklore and customs: *Folklore of Hampshire* by Penny Legg and *Customs in Hampshire* by Tony Foxworthy.

The Late Roman Cemetery at Lankhills and Winchester, a City in the Making: Oxford Archaeology Monographs about excavations at Northgate House, Staple Gardens and the library site in Winchester.

Did you Know? Basingstoke: photographs, facts and a quiz about Basingstoke (e.g. 'Which of Shakespeare's plays mentions Basingstoke?').

Recent cataloguing

We have catalogued the records of Winchester Baptist Church (30A11W), deposited early in 2011, their 150th anniversary year. There were indeed Baptists in Winchester well before 1861, possibly in the 17th century, and definitely from the 1810s, when they had premises in Silver Hill, but the present congregation traces its origins to a visit by the famous preacher Charles Spurgeon in February 1861; they began meeting in a room at the Corn Exchange (now the Discovery Centre), and in 1865 opened their present church in City Road. Their archives range from 1870s minute books and Sunday School records to photographs of recent events such as services and even pantomimes; they also include records of related organisations such as Winchester and District Evangelical Free Church Council, reflecting the church's early ecumenical involvement. A 48-page booklet by Paul Tipple, telling the story of the Winchester Baptists – a much-expanded version of a history produced in 1961 – has just been published; copies are available in the Record Office for £2.

We hold a large archive of the Automobile Association, now based in the county, including two volumes recording the careers of the first 600 AA patrolmen, 1905-13 (73M94/D2/1-2); their names have now been added to the online catalogue. Details in the volumes include name, dates, age and marital status. Some entries are very brief, but some include extra details such as beat areas and dates of promotion. They cover patrolmen across Britain.

Much work has been done on the cataloguing of title deeds and other records deposited by the solicitors Lamb Brooks and Bullock (12M49), mainly from northern Hampshire. Surprise finds include a poor rate book for Baughurst, 1828-9 (12M49/A8/10). There are many title deeds including, for instance, an agreement

for the letting of Malshanger House, Church Oakley, by David Cunynghame to John Hamilton of Weymouth, Dorset in 1814, with a detailed schedule of fixtures, fittings and furniture (12M49/A14/1). The earliest items date from the 17th century, and include a grant of land in Stratfield Saye (12M49/A69/1).

One of our volunteers has recently produced a detailed catalogue of the ledger of Nathaniel Hinves, a gentlemen's outfitter from Lyndhurst, c.1824-38 (159A10/1). Given the difficulties often found in tracing the careers of domestic servants, it is useful to find accounts for 'Mr Freeman', butler to H C Compton [of Minstead Manor House], John James, groom to [Percival] Lewis [of Lymington], the Marchioness of Londonderry's former coachman Peirce, and several servants of Colonel [Edward Perry] Buckley.

The same volunteer has also catalogued some ledgers kept by John Hellis of Odiham, carpenter, 1853-62, and received among the records of a later Odiham builder, J T Barton (85A11). They contain detailed customer accounts, including entries for carpentry and building work done at numerous private houses in the Odiham area, and prominent buildings such as the National School, the Almshouses and the Rectory. Unusual entries include a detailed bill for work on the organ in Odiham Church, with a memorandum that the organist Mr Cobby 'played the organ on Sunday April 14 [18]61 for the first time when altered to a finger organ'.

Events and activities at Hampshire Record Office

Exhibitions, in the Record Office foyer unless otherwise indicated

2 Jul-1 Sept: *The Olympics in Hampshire*: exhibition highlighting Olympians and Paralympians with Hampshire connections, venues and locations in Hampshire used for the 1908 and 1948 London Games, and the Olympic torch route through Hampshire in 1948.

21 Jul-29 Sept (in the top-floor gallery): another chance to see: *Digging in the Archives*: a botanical journey



Photograph of a runner coming through Nether Wallop with the Olympic torch in 1948 (141M83/131).]

round the county (coinciding with the exhibition *International Garden Photographer of the Year* on show at Winchester Discovery Centre).

5 Sept-29 Nov: WARG: 40 years of Winchester's local archaeological society.

2 Oct-31 Dec (in the top-floor gallery): *Danemark to St Bede*: the celebration of a school's century.

Dec 2012-Jan 2013 (dates to be confirmed): the centenary of Winchester Operatic Society.

In the 2013 exhibition programme we are hoping to include displays about the Showpeople of Hampshire project, the 250th anniversary of Barings

Bank (also featuring links between the Baring family and Hampshire), and a research project into some of the houses of East Meon.

Lunchtime lectures: last Thursday of each month, except Dec, 1.15-1.45pm, no need to book. Free, donations in the region of £2 welcomed.

27 Sept: The Folklore of Archaeological Sites in Hampshire, by Alex Godden

25 Oct: WARG: 40 years of Winchester's local archaeological society, by Dick Selwood

29 Nov: Danemark to St Bede: the celebration of a school's century, by Madelaine Smith

Beginners' evenings and workshops

Our beginners' evenings help you start family history research. £10. Tues 18 Sept, 6-8pm, or Thurs. 8 Nov, 2-4pm. Booking essential, on 01962 846154.

Other workshops: unless otherwise stated, 2-4pm; each session £10 per person. Booking essential, on 01962 846154.

Wed 5 Sept: Militia records.

Fri 28 Sept 2012 and Wed 13 Mar 2013: Meet the archive conservators: find out how archive documents suffer damage through poor storage, damp and pests, and how conservators repair the damage and protect archives for their long-term future.

Fri 21 Sept: Tracing airborne ancestors, at Farnborough Library: Do you have a pilot, aircraft engineer or rating in your family tree? Do you want to find out more about him? We are holding an event on 21 September at Farnborough Library on the many types of record, from different collections, which throw light on the careers of your airborne ancestors; what they did, where they served, and what life was like in the RFC, RAF and RNAS. The programme is still to be confirmed but will include William Spencer (Principal Specialist: Military Records, The National Archives), and speakers from the Fleet Air Arm and RAF Museums. There will be a charge for the event, and a visit to The National Aerospace Library will be included in the cost for the day. Please contact Heather Needham (heather.needham@hants.gov.uk) for more information.

Tues 9 Oct: choice of half day (£10) or full day (£15): *Reading and interpreting correspondence.* Professor Chris Woolgar (of the Hartley Library, University of Southampton) and archivists from HRO will help you read examples of correspondence from previous centuries, and also explain the background behind the ways in which our ancestors wrote their correspondence, with a particular focus on the letters of British diplomats.

Mon 15 Oct, 2-4pm: Making the most of the computers at Hampshire Record Office: How to get the most out of the archive catalogue. How to get the most out of our website. Our collection of archive CDs. Some family and local history websites.

Wed 24 Oct: The Home Guard.

Tues 20 Nov: Reading old wills and inventories.

Tues 22 Jan 2013: Paupers and workhouses: explore records that reveal the hardships faced by past generations, and find out the background behind documents such as settlement certificates and removal orders.

Wed 6 Feb: House history for beginners: how to start researching the story of your house and its occupants,

its place in the history of the local community, or what was there before it was built.

Tues 19 Feb: Reading old handwriting for beginners.

Wed 20 Feb: In Riflemen's Footsteps: Tracing Riflemen and their campaigns: Use the regimental archive to trace ancestors in three of the finest and most famous regiments in the British Army (Royal Green Jackets, Rifle Brigade and King's Royal Rifle Corps). Follow in the footsteps of soldiers serving in North America, India, the Peninsula, Waterloo, Crimea, South Africa, New Zealand and the two World Wars.

Tues 26 Feb: Reading old handwriting in Latin.

On the afternoon of Sat 20 Oct we hope to hold a special event for Hampshire children with disabilities, and their families, in the form of an exciting interactive drama about the 17th century, covering the themes of health, Civil War and royal entertainment, inspired by documents held at the Record Office. Children will have an opportunity to decorate their own masks to wear in a Royal Masque and meet re-enactors from the Stuart period. There will be a small charge per child. Booking essential – please ring 01962 846154 for more details.

The Queen's Diamond Jubilee

Our exhibition 'The Queen and Hampshire: a Diamond Jubilee celebration', exploring the Queen's links with Hampshire, such as visits she has made to the county and the ways in which Hampshire people have celebrated milestones in her life, is now touring Hampshire libraries: venues in late August and September are expected to include Waterlooville, Portchester and Netley. From the autumn it will be available for loan to local organisations: to borrow this, or one of a range of other exhibitions which we have produced, please contact me.

We should be very pleased to receive leaflets, posters, programmes, menus, photographs etc relating to Diamond Jubilee celebrations in Hampshire streets, villages and towns. Posters and the like should ideally be sent as hard-copy items to David Rymill at Hampshire Record Office, Sussex Street, Winchester, Hants SO23 8TH. Photographs can be sent as prints, but if they were taken in digital format it is better to send them as digital images by email to archives.trust@hants.gov.uk or by post on a CD, so that we can keep them digitally which should provide the best long-term storage. It is best if photographs are sent as jpgs or tiffs; it is not so easy for us to deal with photographs uploaded via websites. Photographs of the Olympic torch's journey through Hampshire, and material relating to local events marking this, would also be gratefully received.

Opening hours

On Thursday evenings we are now open till 7pm (last orders for documents 4.45pm). Thursday evenings will continue to be open to all, but a livelier learning environment will be encouraged with groups especially welcome, and we plan to run occasional workshops.

Because the search room will probably, by the time you read this, have been closed because of building work from 4 to 17 August (with a possible extension to 18 August), we will not be having our usual closed week in December; we apologise for any inconvenience the work in August has caused.

book reviews book reviews book reviews book reviews book reviews

Barry Jolly, **Mrs Whitby's Locket: The Story of Captain John Whitby, England's Youngest Ever Naval Captain, and His Redoubtable Wife**, Milford-on-Sea Historical Record Society, 2011; pp.96.

On Christmas Day 1802 Newlands Manor, a mansion house about $\frac{3}{4}$ mile north of Milford-on-Sea, was severely damaged by fire. In the following year it was bought by its tenant Admiral Sir William Cornwallis (d. 1819) and rebuilt in Gothic style under the supervision of Mary Anne Theresa Whitby (d. 1850). She was the wife of Cornwallis's protégé Captain John Whitby, who died in 1816 at the age of 31. The locket of Barry Jolly's title was given by Captain Whitby to his wife in 1805 and is now in the Victoria and Albert Museum. Cornwallis treated the widowed Mrs Whitby as a daughter and left her most of his considerable estate, making her a very wealthy woman. She was later known for breeding silkworms in Hampshire, about which she corresponded with Charles Darwin. The interlocking lives of Cornwallis and the Whitbys are the subject of this entertaining and well illustrated book, which focuses on the naval war with France during the Napoleonic era. A joint memorial to Cornwallis and Captain and Mrs Whitby was erected in Milford church by the Whitbys' daughter Theresa West (d. 1886). Portraits of John and Mary Anne Theresa hang at the National Trust's Sizergh Castle in Cumbria, home of the Strickland family, descendants of the Wests. Their story, apparently little known, is well told.

Mark Page

Alison M Deveson, **Whitchurch Methodists: The Story So Far**, Whitchurch, 2012; pp.65, £7.50+£1 p&p from the author at 8 Lynch Hill Park, Whitchurch, RG28 7 NF.

This attractive and well written booklet commemorates the 200th anniversary of the opening of the Wesleyan Methodist church in Whitchurch in 1812. The fortunes of the church, and its ministers and congregations, are traced, with some vivid descriptions of key events. These included the arrival of the Primitive Methodists in the area in the 1830s and, more controversially, the Salvation Army's temperance campaign in the 1880s, which provoked some ugly confrontations with the townspeople.

A schoolroom was added in 1904, but a proposed rebuilding of the church proved to be unaffordable. Instead it was remodelled and extended in 1926. The Primitive Methodist church closed in 1967, finally effecting the unification of the two traditions in the town, but in the later 20th century the membership continued to decline. In 2010 Whitchurch was included



*Whitchurch Methodist Church
© Copyright Michael Ford.
Licensed for reuse under Creative Commons Licence.*

in a circuit of 10 churches in Hampshire and Berkshire. This is a welcome addition to a resurgent interest in Nonconformity in the county, which will provide useful source material for students of wider religious history in the 19th and 20th centuries.

Mark Page

Jane Hurst, **Alton's Breweries**, privately published, 2012; pp.44, £3+50p p&p from Jane Hurst, 82 The Butts, Alton, GU34 1RD.

Commercial brewing has taken place in Alton since the 17th century, and is represented today by the Molson Coors brewery on a site opened in 1962. Jane Hurst's history of the town's brewers focuses on the principal families involved, the brewery buildings and stock (especially as described in insurance records), and the sale and purchase of the businesses. From the 18th century to 1970 the two main breweries were those established at the Swan inn, sold to Courage in 1903, and at premises in Turk Street owned by the Baverstock family, later taken over by Crowley & Co. Much useful information is included, though I was left hankering for more. How many people were employed in the breweries? How important were they to the town's economy? Was the beer sold only in the Alton area or further afield? A reference to an increase in sales during the Napoleonic wars hints at temporary expansion, but we are left wondering about longer-term trends.

Mark Page

Alton Papers, no. 15, 2011; pp.48, £3+50p p&p from Jane Hurst, 82 The Butts, Alton GU34 1RD.

Evidence of the 16th- to 18th-century building which became the Allen Gallery is presented in a reprinted article by the late Georgia Smith. Martin Morris discusses the building of the tower and spire of the parish church in 1881 and the ring of bells commissioned for it. A treble, second, and tenor were purchased from the Whitechapel foundry of Mears and Stainbank, which remained until six new bells were cast in 2006.

Sister Ceilia Jackson recalls her childhood on Jordans Farm north of the town in the 1920s. Pets, food, the weather, trips to Alton, a local pilot, gypsies, the fair, and school are among the themes remembered. Two articles by Jane Hurst cover a fire at Wootey's Farm in 1905 and Alton's first cinemas, opened in 1902 and 1912. The Normandy Street 'picture palace' also hosted other entertainments and is preparing to celebrate its centenary. Jean Stevenson remembers living at Amery Farm, and obituaries of two 19th-century emigrants to New Zealand are reproduced.

Mark Page

Historic Buildings

Editor: Edward Roberts, Grove House, Cheriton, SO24 0QQ
Email: edward.roberts15@btinternet.com

Visit to Bishop's Waltham Palace

David Whiter

On June 9 a sizeable group gathered at Bishops Waltham for a visit memorable on two counts – it failed to rain (unlike most of May and June) and a succinct explanation of the complex and fascinating history of the Bishop of Winchester's Palace.

We met in the Crown Inn opposite, and Edward Roberts demonstrated its development from a fifteenth century hall house into the extended range of buildings exemplifying many periods, extensions and makeovers. Its most famous guest was the prisoner Admiral Villeneuve, losing admiral of the Battle of Trafalgar, who was given leave to attend the funeral of his opponent Nelson.

Then we moved to the Palace site. Winchester has always been one of the premier bishoprics since the Bishop received Waltham in 904 in exchange for Portchester castle which went to the king. Its continuing importance is clear

from the attendance of Holy Roman Emperor Charles V at a convention there in 1522. John Hare, who has extensively investigated the site, traced the buildings from Henri de Blois' initial chapel and hall through the defences thrown up in the Anarchy 1136 to 1154 and Henry II's slighting of these defences. Henri de Blois was able to resume improvements after his return from exile. Later bishops including William of Wykeham and Henry Beaufort contrived to extend the facilities skilfully on the constricted site. At the end of the fifteenth century Beaufort's long range of lodgings was improved, part now remaining as a museum and a reconstruction of the domestic style of the period.

After lunch Edward Roberts explored the context of the Palace, the town, the park and the sophisticated fishponds. We saw traces of the fishpond system in the delightful gardens of Palace House of Mr and Mrs Lovell, who provided a sumptuous tea to end a brilliant visit.

A Wall Painting at the Church of St Andrew, Timsbury, Hampshire.

Roger Harris

The church (listed grade II*) is situated just north of Romsey in the Test Valley and is described as being C13, with a C15 chancel. Small additions, such as the porch and bellcote, are C16 and there were restorations to the fabric in the C18 and again in 1847. The most

church at this date, was that which still survives on the jambs of the south door. Here, there are small areas of very bright red ochre, with what appears to be a broad black framing line, together with fragmentary narrow lines of decoration or text, also in black.

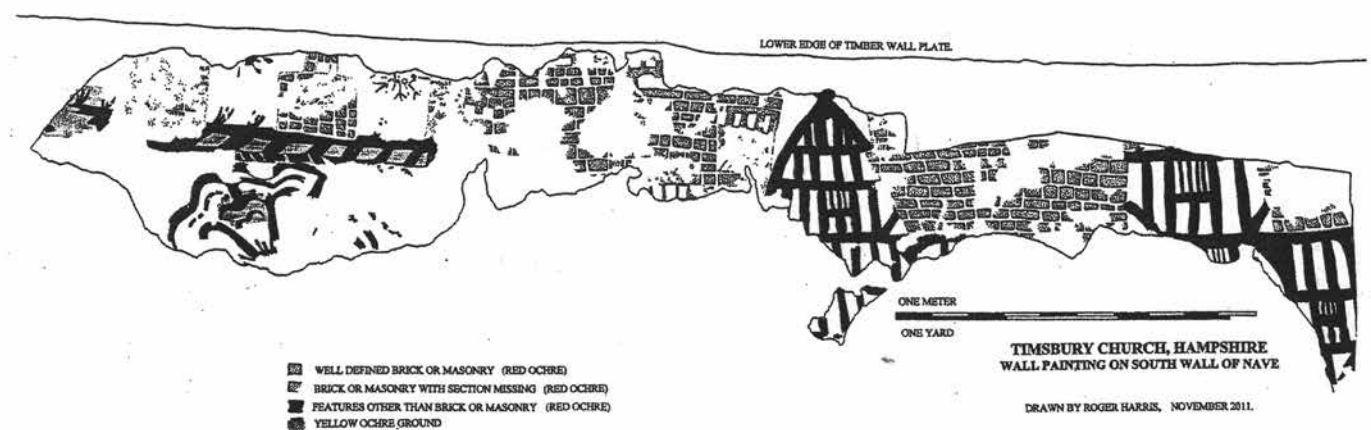

Fig. 1. A drawing of the wall paintings at Timsbury church (the author).

recent re-ordering of the structure was in 1999, which involved blocking the west door and inserting a small traceried memorial window in its place.

It is understood that during the remodelling of the west door, some fragmentary evidence of a wall painting was observed.

The only other painted wall plaster visible in the

In 2003, a C19 wall memorial, fixed directly above the south door and resting on two stone corbels, fell to the floor, the single iron retaining cramp having rusted away. The memorial carried with it most of the upper layers of limewash which it covered, together with a large adjacent section of limewash to the east side of the memorial. Interior decoration work was under way at the time, and the contractors on site were able to make

good the plaster around the newly revealed painting.

The area of painting exposed, approximately 4m long, and a maximum of 1 m high, shows what appears to be a complex of buildings, some timber framed and others constructed in either brick or stone, and perhaps roofed with tiles. The palette is limited to mainly red ochre of varying tone, with some areas of yellow ochre and also white which is used to paint in the mortar joints of the brickwork or masonry. There are some rather ephemeral and ill defined areas of pale yellow and pink, which may simply be where the red and yellow ochres have been spread at some time post painting. A cursory examination suggests that the painting is all of one phase, and there is no obvious earlier paint scheme beneath.

At first glance the subject is uncomplicated, with a timber framed house depicted in much of the western side of the exposed painting, and mainly brick buildings on the eastern side, however there are some unusual details which are described below. For ease of description, the arbitrary division into east and west halves of the painting will be retained.

The western half of the painting.

Most of this section was originally covered by the C19 memorial and contains most, if not all, of the timber framed structures depicted in the painting. On the left



Fig. 2. The western half of the wall paintings

side is a timber framed gable with a single unglazed mullion window, but with part of the right hand diagonal roof timber missing, in its place is depicted brickwork or tiling which also occupies the central portion of the painting. This brick/tiling appears to have been painted by first blocking out the entire area in dark red ochre, and then marking out the mortar joints with white over-painting. The right side of the painting is mainly given over to the elevation of a timber-framed structure with three unglazed mullion windows, but with a small area of brickwork or masonry in the upper western corner.

The eastern half of the wall painting.



Fig. 2. The eastern half of the wall paintings

The paint surface here is less well preserved, but the picture that survives consists largely of brickwork,

masonry or just possibly tiles. As with the brickwork mentioned above, it appears to have been initially blocked out in solid red ochre, with the white joint lines added later. Represented below the brickwork on the eastern half are what may be two horizontal timbers, closely spaced, between which are a number of diagonal cross struts, the spaces formed between are filled with a bright yellow ochre.

The upper section of brick or masonry, just to the left of the timber framed gable, has some well defined areas of plain plaster with no brick or masonry shown. These appear as a vertical band, a 'V' shape and also a curving band, but are quite inexplicable. Likewise, to the left of the area, emerging from beneath the overburden of undisturbed limewash above, are two depictions of what might be mistaken for the legs of cartoon birds. They are clearly not bird's feet, but again the image is inexplicable.

Resting on the horizontal timbers is one, perhaps two, box like brick structures which may represent



Fig. 4. Cracks in the plaster at the edge of the wall paintings.

chimneys. Between these are shown pairs of what may be stylised plants. Beneath the horizontal timbers are a number of flowing lines in red ochre. The plaster here is fragmentary but the design could represent a large rose, an area of water, or even a small hillock.

Present condition of the painting.

Most of the paint film appears to be well attached to the plaster substrate. However, a small section of painted plaster at the extreme western end is partially detached, and is at risk of falling in the very near future. This forms one end of a horizontal crack in the plaster nearly one meter long, which is bulging out from the wall and which may be caused by compression of the wall at this point. There is no obvious reason for this, but the presence of a decaying horizontal timber within the wall cannot be ruled out.

Although most of the crack passes through whitewashed plaster, it is fair to assume that there may be more of the wall painting concealed here.



St Andrews, Timsbury © Copyright Michael Ford. Licensed for reuse under Creative Commons Licence.

An early Cruck House at No 1 Somerset's Cottages, Bentley, Hampshire.

Bill Fergie

Introduction

The core of a medieval cruck framed house incorporated within No 1 Somerset's Cottages (see Figs 1& 2), has been known about for some time. The late Joan Harding, the founder and initial driving force behind the very successful Surrey Domestic Buildings Research Group, was tempted to stray across the county boundary to record it in 1976. Her report, DBRG 1500, is presumably safely lodged in the Group's archive and a copy was also deposited with the National Monuments Record. In December 1995 Liz Lewis, Peter Smith and Edward Roberts of the Hampshire Buildings Survey Group also visited and recorded both No 1 and its neighbour No 2. Liz's report is held by that Group but has not been published. In 2008 the opportunity arose for No 1 to be dated by dendrochronology. Not only was the owner willing to have her house dated - the same owner who had agreed to her house being crawled over at least twice before - but she was also prepared to contribute to the cost. With the Historic Buildings Section of the Field Club also prepared to give a grant in return for assurances about future publication, the probability was that a conclusive report on No 1 Somerset's Cottages could finally be published.

Thirty five years ago Joan Harding was a pioneer in the study of historic vernacular domestic buildings in Surrey, and Liz Lewis, Richard Warmington and Edward Roberts were beginning the same studies in Hampshire. At that time the science of dendrochronology was in its infancy and not the relatively accessible tool it has become today. Edward Roberts will readily acknowledge the debt that his book on Hampshire houses¹ owes to this relatively new science. Prior to its availability, and where no documentary evidence was available, comparative typology and experience in the field were all that could be relied upon to arrive at an approximate date for a timber framed building. It is noteworthy that both Joan Harding and Liz Lewis were of the opinion that No 1 Somerset's Cottages dated from the 15th Century, although Joan ventured the opinion that it was "probably very early fifteenth century". However, because Joan did not have the benefit of all the studies that would eventually be incorporated in N W Alcock's catalogue of cruck construction, only published in 1981², she also identified the central frame of the structure as a "base cruck". We now know that it should be regarded as a "truncated cruck". The two forms are visually rather similar but have been conclusively shown to have a different ancestry, and also a somewhat different geographical distribution.

In presenting a fairly definitive composite account of the studies of No 1 Somerset's Cottages, I am extremely grateful to my predecessors for the work

they did, and also to Mary Ford of the Hampshire Field Club who arranged for access and helped me with my own investigation. I am also indebted to Edward Roberts whose help with my interpretation is gratefully acknowledged. Having the benefit of a felling date of

1311/12 resulting from the recent dendrochronological examination also allows me to draw some conclusions about the building in its Hampshire context.

Cruck Construction in Hampshire

Traditionally cruck buildings incorporate a ridge beam and side purlins as the means of supporting the rafters. Indeed, it can be argued that one of the main features of a cruck frame is that the blades come together at or near the apex of the roof to support the ridge, which, with the side

purlins, supports the rafters. Crucks in Hampshire do, however, seem to be a law unto themselves, and buildings exhibit not only a variety of apex details within a single building but, occasionally, even mixed cruck and box frame building techniques. Additionally, some cruck buildings employ, or incorporate, an unusual shortened cruck frame. Alcock's catalogue of 1981 identified this as a Type W apex, and a plot of the relatively small number of known examples shows that they occur in a small cluster across the counties of Buckinghamshire, Oxfordshire and Hampshire, with a very few extending west into Berkshire³. The cruck blades in a typical Type W frame stop at or just above roof purlin level, and in many cases the rafters are merely carried up in pairs and halved at the apex of the roof without the benefit of a ridge beam. However, in Hampshire Type W frames are found in buildings which also contain full cruck frames and ridge beams. In these cases it was sometimes considered necessary for them to be adapted to make a connection with the ridge.

A common adaptation was the introduction of a king post between the collar and the ridge. This was the solution at No 1 Somerset's Cottages, and has also been noted at The Nook, Dummer (1424)⁴, and in a further undated cruck house, Lime Trees at Crondall⁵. At The Mount, Silchester (c1405)⁶, the solution is more complex, with extension timbers being added to the backs of the truncated cruck blades in the form of principal rafters which support a diagonally set ridge on a small yoke. A further cruck framed house nearby at Dogmersfield (1335/6)⁷ has intriguing similarities to the Bentley cruck, but its Type W central hall truss appears not to have been connected to the ridge. More will be said about this last building later because of its close proximity and the similarities between its carpentry and that of No 1 Somerset's Cottages.



Fig. 1 No 1 Somerset's Cottages from the south. The 17th century replacement for the original eastern bay (now within No 2) is visible to the right.

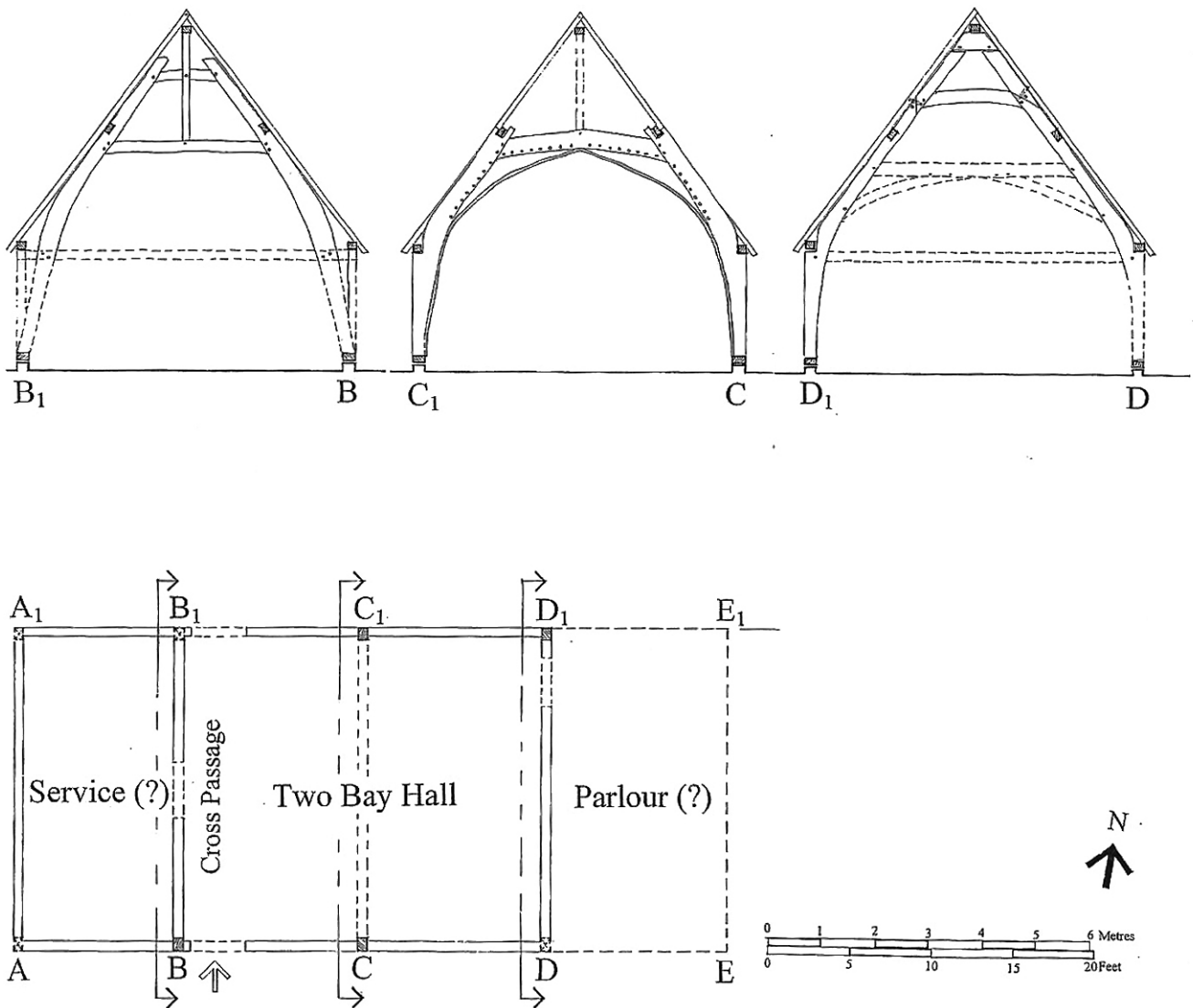

Fig. 2 Plan and Sections.

The rather surprising boundary which is clearly evident on the distribution map of surviving crucks in England shown in *The Cruck Catalogue*⁸ shows them to be concentrated in the north and west, with none in the south-east. Lying as it does on the eastern boundary of the area containing crucks it is not surprising that Hampshire has borrowed something from each side of the divide. However, crucks in the county also exhibit a degree of variety which suggests that the carpenters involved were very pragmatic and ingenious in the way they exploited the available timber to best effect. Moreover, crucks in Hampshire are generally well constructed and exhibit fine carpentry details, and the pragmatism of the carpenters appears not just to have been a matter of 'make do and mend'.

Cruck blades meeting at the apex of the roof largely determine the span of the building. However, smaller timbers can be adapted to meet the profile of the largest frame, and still support the ridge. One of the assets of the Type W frame is that it has considerable flexibility as far as the span of the building is concerned. Merely extending the length of the collar linking the tops of the blades, and of any arch braces incorporated

to give the frame strength, allows it to be extended in width. This means that, to some degree, fine curved timbers which might not otherwise be long enough for a conventional cruck building can be used effectively. None of the three surviving cruck frames at No 1 Somerset's Cottages actually have blades which extend all the way to the ridge, although two are very nearly long enough and by slightly different means have managed to achieve the desired support for the ridge. The blades of the central hall truss, however, fall well short of the required length, but as part of a Type W frame their other impressive dimensions have not been wasted, and they would have made a striking visual impact at the most important location in the building, the centre of the two bay open hall (see Fig.3).

The Surviving Timber Frame in No 1 Somerset's Cottages

Three trusses of a probable four bay, five truss, timber framed cruck house survive. Fig.2 indicates the probable original plan arrangement, together with drawings of the three surviving trusses. The truss locations are indicated on the plan with the letters A – E from west to east. It is likely that the largely intact two

bay central hall (B – D) was originally flanked by an in-line service bay (A – B) and a parlour bay (D – E). The bay to the west of the hall is still in-line but has been rebuilt in brick. A short length of purlin running west from truss B – B₁ testifies to the original in-line nature of this bay. The eastern bay was replaced, probably in the 17th century, by a conventionally framed two storey, two bay, cross wing structure, which is now incorporated within a separate property, No 2 Somerset's Cottages. This latter structure was not examined as part of the latest investigation of No 1, but we do have the benefit of Liz Lewis's assessment of it from her visit in 1995. It is a possibility that the hall was originally flanked by an earlier cross wing at this end, but there are a number of Hampshire examples of cruck houses with in-line bays at both ends of the hall, and this is considered to have been the likely arrangement here.

As has been said, the three surviving frames of



Fig. 3 Central hall truss, which would have been the centrepiece of the two bay open hall.

the original cruck structure are all different. This is particularly true of the design of the upper parts of the frames. The Type W central hall truss is constructed of massive timbers, and it is easy to see why the carpenter did not want to discard them as being too short, but choose instead to use them as part of the centrepiece of his structure. The truss incorporates arch braced reinforcement between the cruck blades and the collar, and each brace is tenoned into both the blade and the collar and secured to each with eight pegs. The inside edges of the braces and blades are chamfered, and the timbers are still tightly locked together by the multiplicity of their pegging. Because this truss is of Type W form, in a building incorporating a ridge, some adaptation was considered necessary for it to help support this member. The chosen solution was a king post between the collar and the ridge. The post is missing but the mortices and the peg holes in the collar and ridge are evidence for its former existence.

The other two surviving cruck trusses, at either end of the hall, can be regarded as "full" crucks in that their blades extend more or less to the ridge. The truss between the hall and the western bay (B – B₁) has a Type C apex in Alcock's classification, with the crucks joined at the top to a yoke on which the horizontally set ridge beam rests. However, the blades only extend as far as the yoke because short, neatly scarfed but not symmetrical, extensions were added to each to ensure they had adequate length. The blades of the truss at the other end of the hall (D – D₁) also stop short of the

ridge but here, instead of extending them, the carpenter provided a short king post which links two high collars and then supports the ridge. The result is a variation of a Type F1 apex.

Only one wind brace survives, and this links the southern cruck blade of the truss at the eastern end of the hall to the southern purlin. The brace is almost square in section. There is no evidence for wind braces associated with the central truss, and on the evidence of the surviving brace it would appear that braces were only located in the four corners of the hall. This would have been both a symmetrical and structurally satisfactory arrangement.

Most of the original rafters survive over hall bay C – D, and they are heavily sooted to confirm the original existence of an open fire. In the centre of this bay pegs in the rafters suggest a former smoke louvre, but the form it took is unclear.

The Plan Arrangement

Having suggested a plan form of a two bay hall flanked by in-line service and parlour bays, it is necessary to discuss the orientation of the hall and therefore which flanking bay was originally which. The balance of historical evidence suggests that the

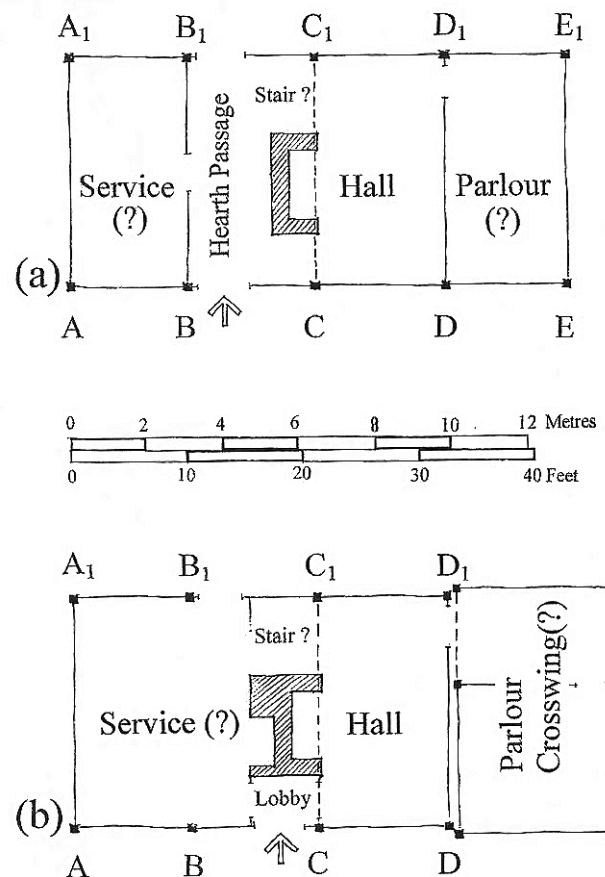

Fig. 4 Possible evolution of the plan in the 16th and 17th centuries:-

- (a) 16th century – Flooring of the open hall, and possibly also of the end bays if not originally floored. Chimney stack inserted and the through passage retained to create a "hearth passage" plan.
- (b) 17th century – Eastern cruck bay replaced with a conventionally framed two storey cross wing. The addition of a second hearth and incorporation of the cross passage into the service room. Eastward movement of the main doorway to form a "lobby entrance" plan.

17th Century timber framed structure to the east of the hall would have replaced the parlour bay at the high end of the hall. It was also common for a post medieval fireplace and chimney to be located at the low end of the hall or within the cross passage, thus converting the medieval plan into either a "hearth passage" plan or a "lobby entrance" plan. Fig.4 shows a possible evolution of the plan of the house and indicates how the former may have preceded the latter in this case. Additionally, it is surprising how often the front door, as here, and sometimes the back door as well, have remained close to their original locations over the centuries, to reflect the location of the medieval cross passage at the low end of the hall.

The one piece of conflicting evidence about the original layout is that suggested by the location of the pegs in the rafters indicating a smoke louvre in the roof at the high end of the hall. It would be more usual to find the louvre nearer the cross passage, although this is not invariably the case. On balance, it seems the western bay was the service bay and that to the east was the parlour bay. However, with both ends rebuilt, and with much of what survives of the original timber framing hidden by later work, it is not possible to be certain.

Conclusion

This building is another example of a structure incorporating a number of cruck variants. This seems to have been a Hampshire speciality, and underlines the pragmatism of the carpenters. If the builder has access to large curved timbers of a consistent length it is reasonable to adopt a consistent design of frame throughout the building. If the timber available is in a variety of lengths it is eminently practical to determine the overall dimensions of the building that could reasonably be achieved, and then to make the timbers fit, either by adopting the very flexible Type W frame or by extending shorter timbers. This latter option can be achieved either by actually lengthening the blades or by linking them at their apexes with a collar and achieving the extra height to the ridge with a small king post.

The felling date of 1311/12 determined by dendrocronology makes the Bentley house the earliest domestic cruck building so far dated in the county. As indicated above it shares features with another early cruck, known as Lords and Ladies, less than 5 miles away as the crow flies at Dogmersfield, with a felling date in the winter of 1335/6. Three common features of the buildings are:-

1 - the use of a neatly chamfered Type W cruck

truss in the centre of a two bay hall,

2 - the incorporation of two more conventional full crucks at either end of the hall – in one case the frames are of identical design in the two buildings and in the other case very similar, and

3 - the use of almost straight, square section, windbraces – such windbraces appear to be an early feature in Hampshire. In the 15th and earlier 16th centuries they were curved and became progressively thinner in relation to their width.

The Dogmersfield house also has evidence for a smoke louvre, although at the more usual low end of the hall. It is, however, slightly smaller in all its dimensions, perhaps reflecting the size of timbers available, and the hall bays were both fully windbraced. However, despite specific investigation, it appears that there was never any connection between the collar of the Type W hall truss and the ridge. The decision to span the length of the hall with the ridge, without an intermediate support, might be partly explained by the fact that the hall at Bentley is 6.5 metres (21 feet) long against 5 metres (16 feet) at Dogmersfield; and partly by the ridge beam in the latter building being of slightly increased scantling. Despite a time interval of almost 25 years between the construction of the two buildings, their relative similarity and proximity hint at the possibility that there might have been some link between the carpenters who built them.

The Type W truncated cruck date range in Hampshire now extends for at least two centuries; from 1311/12 at No 1 Somerset's Cottages, Bentley, to 1496-1528 at the recently dated Hatch Cottage, Tadley⁹.

Note

The dating of No 1 Somerset's Cottages was commissioned on behalf of the owner by the Hampshire Buildings Survey Group and paid for by the owner and the Hampshire Field Club and Archaeological Society (Historic Buildings Section).

References

1. Roberts E 2003, *Hampshire Houses 1250 – 1700: Their dating and development*.
2. Alcock N W 1981, *Cruck construction: an introduction and catalogue*.
3. Alcock N W 1981, 8 & 21.
4. Roberts E 2003, 21, 132, 133 & 210.
5. Alcock N W 1981, 120
6. Roberts E 2003, 22 & 23.
7. Vernacular Architecture Vol.38 (2007) 127.
8. Alcock N W 1981, 6
9. Vernacular Architecture Vol.41 (2010) 107.

The Former Anchor Public House, London Street, Basingstoke

Bill Fergie

The Anchor appears to have been one of a large number of inns in and around London Street and Winchester Street. These two streets formed part of the main east-

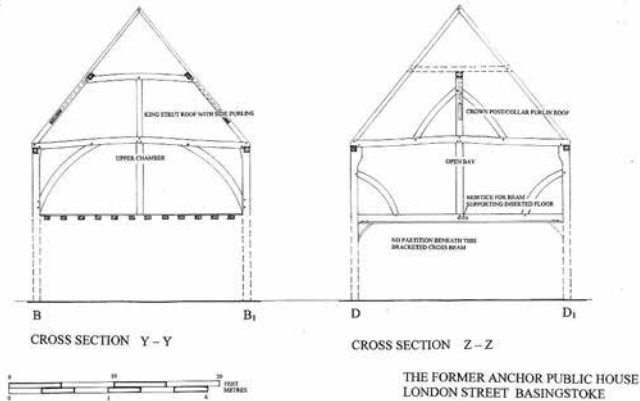

west road through Basingstoke, which was not only on one of the main routes from London to Winchester and Southampton but was also where the road forked for travellers going to the West Country via Sarum Hill. These inns would have looked after the needs of travellers on an east/west route which, from medieval times, fulfilled much of the role of the present M3 and M4 motorways.

The refurbishment and extension of The Anchor some years ago revealed two early timber framed structures. Somewhat surprisingly they were not on the present frontage of London Street but were separated from it by a further, later, range of building. This

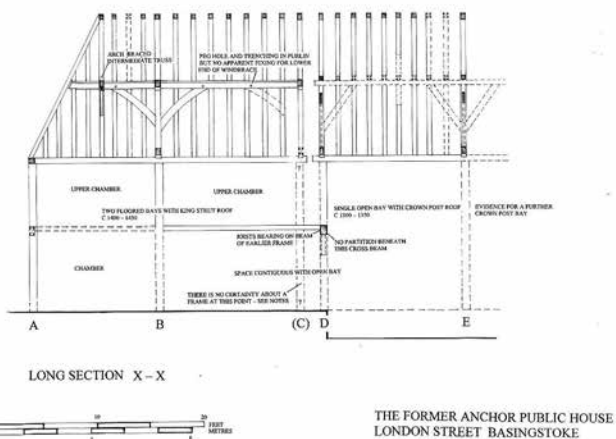

pointed to the intriguing possibility that at least parts of London Street had once been rather wider, and that the later buildings represent encroachment.

The early buildings only really survive above first floor level. Even here major elements are missing. However, sufficient evidence survives for the form of both structures to be largely recreated. The drawings illustrate this recreation, with surviving timbers indicated by solid lines and missing or replacement timbers shown dotted. The ground floor plan can merely be indicated diagrammatically with the

structural frames identified by the letters A to E.

A single bay of the earlier building, the frames of which are denoted D and E on the drawings, survives to the east. Heavy sooting on the surviving roof timbers indicates an open hall, and its roof construction is of the crown post/collar purlin type. There is evidence in the carpentry which indicates that there was originally at least one further bay to the east. The crown post roof type is associated with the south-east of the country where it was commonly employed in the 14th and 15th centuries. It is a form rather rarer in Hampshire, where examples are found principally in an urban context and date almost exclusively to the 14th century. No other

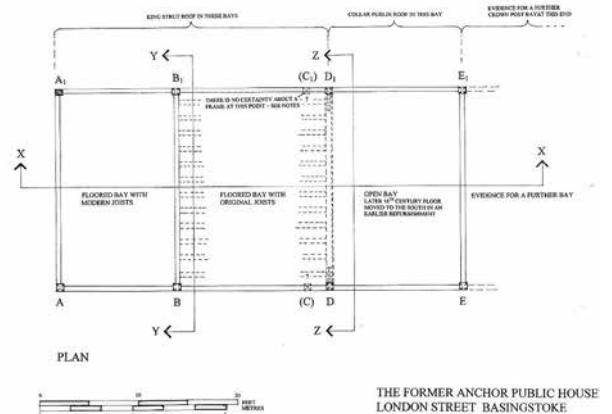

crown post roofs are known in Basingstoke, but the roofs in the parish churches at nearby Dummer and Hartley Wespall exhibit this form of construction. The western building, the two structural bays of which are denoted on the drawings by the letters A, B and (C), is later in date, and contains a king strut roof structure with side purlins, which indicates an early 15th century date. It is radically different in form to the crown post roof and, with its dependence on side purlins, looks to the cruck tradition of the western part of the country for its antecedents. This later structure was always floored. It had been hoped that precise dates for the structures would have been established by dendrochronology but a recent attempt unfortunately proved unsuccessful.

What is clear is that these structures represent the earliest timber framing so far identified in Basingstoke and the buildings are therefore significant survivals. Their location just behind the London Street frontage may indicate that at least parts of the street, already quite wide, were once rather wider. This in turn may indicate a market function, the residue of which may have been the pig market until comparatively recent times located in front of the nearby Almshouses. The buildings may well have been built as part of an inn, perhaps one of the earlier such buildings specifically designed to cater for travellers on this important route. It is a pity that their fragmentary nature makes it impossible to understand the precise functions of the various spaces.

Archaeology

Editor: David Allen, c/o Museums & Archive Service, Chilcomb House, Bar End, Winchester, SO23 8RD
tel (01962) 826738; email: musmda@hants.gov.uk

Editorial

David Allen

Alan J Jacobs

Alan Jacobs, Collections Manager (Archaeology) at the Hampshire Museums Service for three and a half years, before going to Essex, died of lung cancer on 17th February after a short illness; he was 47. The move away from Wessex had been an 'enforced' one, as the County cut down on its Heritage Services, but we were pleased to hear that Alan had found a position (with the Essex County Unit) which would allow him



Alan discusses the finer points of a stone axe with visitors to a Festival of Archaeology event at Andover Museum – 2009.

plenty of scope to pursue his interests in pottery. Fairly recently married, he and his wife Michelle were looking forward to settling into Witham, near Braintree. Before coming to Hampshire, Alan was employed as a finds specialist by the Worcestershire Archaeology Service.

Those who worked with Alan particularly remember his enthusiasm and commitment to outreach activities. At both Worcester and Hampshire he played

a key role in recruiting volunteers, running sessions in the evenings and at weekends, as well as during work time. While at Worcester he ran a 24-hour pot washing 'potathon' to raise money for *Children in Need*, and at Winchester established 'volunteer Thursdays', took part in *Festival of Archaeology* events and gave the Mayor's Charity Lecture at Abbey House. He was also very committed to developing activities for the visually impaired, in collaboration with Bill Phillips.

Some of his major achievements were 'behind the scenes' however, and he put a tremendous amount of effort into improving the storage conditions for the County Collections. The environmental control of store buildings – never an easy task in spaces that were never intended for that sort of purpose – was taken to new levels and the digital cataloguing of records reached new heights.

Alan supported local society activities whenever he could and was particularly keen to pass on his knowledge of pottery of all periods to those for whom it was a new world. He helped the North East Hampshire Historical & Archaeological Society with their work on the material from 23, Tower Hill, Cove, a pottery production site extending over two phases of activity from 1370-1500 and from 1550-1700, which has been recently published as Vol. 6 in their Journal series.

He is also remembered for his 'interminable supply of bad jokes' which, though guaranteed to make everyone groan, were a small price to pay for the long hours of dedication, a willingness to go the extra mile and readiness to apply himself to every task in hand. Our deepest sympathies go to Michelle and his family.

How does the garden grow?

I haven't been to a management briefing yet (and I'm now casting my mind back across three HCC decades) where 'change' or some suitable synonym, hasn't been one of the key themes. The most recent rounds of informing and encouraging have had a particular point, however, as they've introduced or accompanied a change of approach – Hampshire now has an Arts & Museums Service. They've also had to deliver real cuts – cuts in the work force and in opening times – and herald a new approach where volunteers are key to the delivery of services at a number of



establishments.

One such is Rockbourne Roman Villa, where the site is reduced to a three-day week (Thursday, Friday, Sunday) plus Bank Holiday Mondays. On the other hand it has been able to invest in new interpretation panels, a new all-colour guide book and, with the help of many willing volunteers, the creation of a 'Roman garden'.

There are no traces of a garden layout from the Morley Hewitt excavations of the 1950s to 1970s, and although the excavation of a well did produce cherry and plum stones, hazel nuts, silver birch and hazel bark, pine wood and moss and part of a wicker basket, no comprehensive environmental samples were taken. The garden is therefore a 'freelance' design, based on a visit or two to Brading Villa on the Isle of Wight.

Overseeing the work has been Vanessa Tipton, Volunteer Co-ordinator at Rockbourne (and a number of other museums). The changes that have taken place since the first turves were cut on a very cold January morning are testament to the hard work put in by Vanessa and many others. There's hardly been a sunny day on which to capture progress on camera, but at least the raised beds and 400 box hedge plants haven't

been threatened by drought!

This year is 70-years on from the discovery of the site by A T Morley Hewitt, and the local primary school (Western Downland) recently explored the history of the site and held a reminiscence project interviewing a number of people with 'early' memories of the project, including me! Oh, how the time flies!

The pictures at the bottom of these two pages show the Rockbourne garden developing from bare grass in January to an indication of its final glory in July 2012.

More resource for Basing

Basing House, another site looked after by the County Council, is celebrating another lottery grant success, having attracted a further £600K to go with the £2m recently invested in conserving buildings and improving interpretation. This time the cow shed or Shippon is to be restored, and will end up with a ground floor room meant for community group use – especially archaeology. A five-year Activity Plan accompanied the bid and a key feature is continued archaeological activity at the site by local groups. Other elements of the scheme are a viewing platform, on the top level of the ringwork bank, and further brickwork consolidation.

Quarley Down Ancient Environs Project

The Quarley Down Ancient Environs Project (QDAEP), previously reported in these pages as work on the Cholderton Estate, Ampport, goes from strength to strength and has recently released its *Newsletter 5*, prepared by Cynthia Poole, from which these notes are taken.



Ordnance survey - the offending grenade

Field walking and subsequent processing of finds has been the main activity of the past six months. The greatest excitement was probably caused by the finding of a hand grenade in [field] Grateley Lodge 2: most of the local police spent a relaxing sunny Sunday

afternoon in the field whilst waiting for the bomb disposal personnel to arrive. We must have walked up and down past it numerous times in laying out the grid before Briony [Lalor] finally noticed it on our second day of walking – a real lesson in observation for all of us – do we only find what we expect to find; do we only find what interests us?

The Laundry Excavation

Subsequent to *Newsletter 4*, one of the proposed extensions was completed in the autumn. This was to examine the bones seen in the eastern side of the trench. Excavation revealed the bones were part of an articulated animal probably originally complete. The skeleton was very fragile and the bones poorly preserved and this is at least partly because the skeleton is that of a young sheep. The bones were not fully fused, though soil conditions may also have had an effect on preservation.

The finding of a third animal burial is of interest as this and the sheep found in 2010 were both placed in or close to the boundary of the settlement. The young pig found in trench 4 in 2009 was only a few metres to the NE. A comparable undated burial of a young calf was found in a prehistoric field lynchet during excavations at Horseshoe Meadow in 1995 (Cunliffe and Poole 2000), about 1km to the NE of the site.

Perhaps three burials associated with boundaries (the piglet may lie within the settlement, rather than on a boundary) are too few to suggest a pattern of behaviour, though it does raise the question whether it was a more deliberate than casual disposal of a dead animal. Placing the body at the edge of the field would





The sheep skeleton revealed

be logical in disposing of the corpse, but one might expect if it was just a case of getting rid of it that it was dumped without ceremony. The deposition in a pit with some care suggests that it may have been a significant act.

Field Walking 2011-12

We have achieved a considerable amount in walking five complete fields over the winter season. During this season of field walking we have also been refining our methodology to ensure efficiency and consistency of results, ease of recording and subsequent plotting.

We now have a block of adjacent fields to be able to look at the data over a more extended area than on a field-by-field basis. Until we have covered sufficient area we will not be able to know what represents 'background noise' and at what level or scale we can interpret the material. Intuitively, I think the prehistoric material will pinpoint activity at a smaller scale related to individual settlements, whilst the later assemblage (medieval and later) is likely to be from agricultural activity and will probably have a broader, less focussed pattern though possibly revealing differences between medieval and post-medieval practice. Cholderton consists of a number of outlying farms and it may show some of these have earlier origins. There are also questions of what was the nature of settlement and activity while Quarley hillfort was occupied, and how did this change in the Later Iron Age, once the hillfort had gone out of use? Similarly, what was happening in the Roman period: was this area just part of the cornfields or grazing of Grateley villa or is there other Roman settlement in the area? And is there a significant difference on either side of the river Bourne?

The Woodland Survey 2011-2012

What is emerging from the woodland survey is that there appear to be virtually no earlier earthworks preserved within the woods. One of the reasons for revisiting Windy Dido was to look very carefully at the areas where prehistoric field lynchets and the Windy Dido linear mapped in the adjacent Horseshoe Meadow field disappeared into the woodland. The linear ditch shows on air photos on both sides of the wood and on Google Earth the line appears to continue through the trees, but no evidence was visible on the ground, though it is possible ground cover was already too long in April when the second survey took place. It must be concluded that all earlier earthworks, apart from the barrows, had

already been ploughed out, or were too slight to survive the disturbance resulting from tree planting. Further work on the woodland will focus on the development of the woods themselves and what this represents in relation to emparkment of different areas of the Estate.

What is apparent from the map evidence is that the woods largely represent two phases of emparkment. The present pattern largely represents planting undertaken by Henry Stevens between 1889 and 1926, when he created the Estate. From the earlier maps (the title apportionment maps and conveyance maps at the time Henry Stevens purchased the Estate) there had been an earlier phase of tree planting relating to emparkment and Stevens expanded these areas of woodland or hangars, as well as adding completely new plantations.

It seems very little evidence for the earlier emparkment now survives, though some of the more ancient trees surviving within the woods may relate to this phase. An example may be the beeches along the south-west boundary bank of Windy Dido and on the bank defining an earlier phase of Hills Copse. Many show evidence of pollarding. However, appearances can be deceptive as a line of very similar old beech trees line the south side of a track (possibly a former drive) running west from Cholderton Lodge through Long Belt Wood would appear to have been planted by Henry Stevens on the basis of OS maps from the 1890s.

Scattered single beeches and short lines have been noted within other areas of woodland especially within the Pinetum and Park woods surrounding Cholderton Lodge much of which is known to be planted by Henry Stevens. It is possible some of these may represent an early phase of emparkment or park woodland fossilized within the later plantations not apparent on earlier maps. A few of these ancient beeches have blown over or had to be cut down in recent years: it would be useful to obtain tree-ring counts from their trunks if possible to establish whether they do relate to earlier emparkment, and also to provide information of estimating ages of beech trees planted in parkland for which data are poorly represented.

A common feature of many of these apparently older trees is that they have been planted on a low mound mostly in the region of 5-8m diameter and about 0.5m high. These appear to be deliberate features not a natural accumulation of debris around the base of the tree as no equivalent mounds appear to be developing around the other trees of the plantations.

This suggests that these mounds represent a deliberately constructed feature on which the trees were planted: it is possible research will reveal whether this was intended to make the trees more prominent in the landscape or were thought to improve the chance of survival of the sapling. Further work on the woods will focus on establishing evidence of the earlier emparkment from later tree planting with GPS readings and circumference measurements taken on all trees that appear to belong to this earlier phase.

The project continues. Anyone wishing to take part should contact Cynthia Poole or Briony Lalor.

Cynthia Poole - cynbyn@tesco.net

Briony Lalor - briony@brionylalor.co.uk

References

Cunliffe & Poole, 2000, *The Danebury Environs Programme*, Vol 2 Part 7. Oxford University Monograph 49.

Landscape

Editor: George Campbell, 10 Church Lane, Highfield, Southampton, SO17 1SZ
e-mail: campbell.georgef@gmail.com

Editorial George Campbell

'A man-made landscape' is an expression in common parlance among landscape researchers, where man's influence on the ground is much in evidence. Rarely however, can we name or even tentatively attribute its shaping to some group, much less to an individual. Exceptionally, as Malcolm Walford has proved (below), even someone of humble origins, ambitious and determined, can make his mark on the landscape, if the evidence can be uncovered. The problem of attribution, however, usually lies in the absence of records. But, with the passage of time more evidence has survived as more records have been preserved. Among the most ardent archivists have been the churchmen, and not far behind, the lawyers. In this issue we are indebted to both groups for the survival of records that throw light on two notable contributors to the Hampshire landscape: the first, a medieval prelate; the second, a Victorian MP.

The first invested heavily in education with

the aim of producing a professional body that could contribute to the spiritual, moral and social welfare of the country, especially at a senior level. The schools and colleges he created and inspired others to build are everywhere. The second was a Southampton MP and landowner, who leased and sold his land for building at such prices that he was castigated in the press for 'rapacity in profiting from building development' (1). The overall impact on the landscape of his influence, was described by one contemporary traveller as 'simply a collection of remarkably ugly houses.' (2)

Two things they shared: they both enjoyed great wealth, and each had a pub named after him. Walford's man built his own.

References:

1. HRO 139M71/B17/25 News cuttings from the Morning Leader and the Star, 1909.
2. Moutray Read, D.H. Highways and Byways in Hampshire, p.27, 1908.

William of Wykeham's Contribution to the Educational Landscape

George Campbell

Escorting visitors around Winchester Cathedral past the chantries of the medieval bishops, and being dazzled by their architectural splendour and the effigies of those devout recumbent prelates at prayer, one could be forgiven for believing them to be men devoted exclusively to a spiritual world far removed from the experiences of everyday life. However, they did have secular interests, and in a big way. Several were acquisitive capitalists, highly intelligent, with a good nose for profitable business, and who became extremely wealthy. They were also skilled political manoeuvrers, survivors from the political battlefields of their times. William of Wykeham (c.1324-1404), Henry Beaufort (c.1375-1447), William Waynflete (c.1400-1486) are typical examples. Any of them, were they around today, would have been head-hunted to occupy a seat on the board of Goldman Sachs. But they also had a strong sense of public service, and like many of today's wealthy, were great philanthropists, invariably investing in projects of benefit to society that were seen to have a long-term future, and by which they would be remembered. Wykeham and Waynflete were outstanding in this respect.

William of Wykeham was a great planner, builder and visionary, and an inspiration to others. While his impression on the physical landscape was widespread and sudden, immediately after taking office in 1366 (1), his impact on the cultural landscape, in particular through education, was immense but more gradual. Education was clearly a grande passion. But what

influenced his thinking and decisions? Primarily, was the need to recreate a teaching force after the Black Death, but other major considerations must have been the need for educated public servants particularly for those holding high office. Alongside this must have been an awareness of the circulation of new knowledge, particularly in the sciences and humanities, not always seen in a favourable light by the church; but also an acute consciousness of the increasingly widespread hostility to the church's influence in the 1360s.

Wykeham was also Lord Chancellor, which ensured a place for him at court and kept him closely in touch with parliament. Both enabled him to experience the strong anticlerical views held generally, and a movement away from the church towards a more secular world in this country and on the continent. At the same time it probably deeply concerned him that while as Bishop his duty was to maintain the authority of the church, he could only realistically achieve this with a priesthood that was intellectually recharged and properly equipped with a more broadly based education that reflected the concerns of an increasingly secular society. This must have been reinforced by his close contact with a wide circle of friends (2), many of whom were university educated and widely travelled, for this was the period of the wandering scholar, when universities were rethinking their priorities and their curricula. The latter trend was a response to the wider dissemination of new knowledge in the sciences and philosophy following the fall of Toledo in 1085, and the

acquisition of the extensive library of scientific works of Arab scholars along with their translations of the Greek philosophers. By the 12th century Toledo had become the centre for the study of the Arab achievements and their translation into Latin, the language of European scholars and of the church. Access to mathematics, the sciences and the Greek philosophers, inevitably opened a 'pandora's box' of problems for the church, which, hitherto it had handled as heresies of one sort

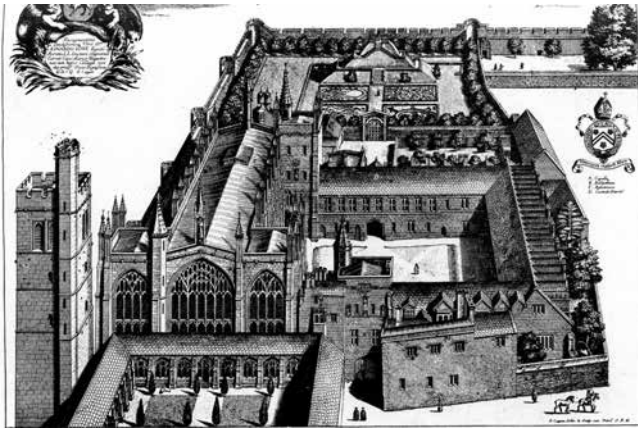

Fig. 1 New College, Oxford.

or another. So, with his notional curricula probably undergoing some revision over time, in the light of his long exposure to such influences, it must have been with considerable fortitude that Wykeham embarked upon his educational projects.

An early task he faced was how to replace the teaching clergy killed off by the Black Death and later plagues. Towards this goal through his joint foundations of New College, Oxford, and its feeder school, Winchester College, he was one of the first to promote the idea of education as a continuing process, and to provide the means of achieving it in a properly planned and purpose built learning environment. His meticulously worded statutes were to ensure that his colleges were secure from interference, and his generous cash endowments to both colleges were to ensure that the seventy poor scholars who were to be the main beneficiaries annually were adequately provided for. Perhaps in doing so he was also mindful of his own humble origins and early hardships (3). It is noteworthy, however, that long before he had embarked upon his building programme he was funding poor scholars in Oxford, many of whom were living in poverty in poor lodging houses in the town (4) and in several of the early halls, precursors of the colleges (5). In addition, in Winchester in 1373, nine years before his college was founded he had organised a school for poor scholars (6).

The layout and design of his two colleges consisted of the component units of chapel, hall and living quarters (dormitories and studies) arranged around a square open space, the quadrangle (fig.1). One architect, William Wynford, had overall responsibility for the entire project of the building of the two colleges, which he saw through in his lifetime. The overwhelming success of this building arrangement can be seen in its almost universal adoption in the later colleges of Oxford and Cambridge, and in other universities over the centuries well into the second half of the 20th, e.g. Connaught Hall, Southampton (1931); St. Catherine's College, Oxford (1962) (fig.2).

To Wykeham, the educational process within the colleges was no less important. Innovatory practices he introduced included the teaching of grammar and the humanities, a tutorial system and efficient administration. He considered grammar to be 'the foundation of all the other liberal arts' (7). The colleges' motto: 'Manners Makyth Man' was uniquely in English rather than Latin, emphasising 'consideration for others' as a foremost principle, and perhaps reflecting a trend to a more widely accessible and more secularised learning. This trend is confirmed in the curriculum set out in his College Statutes, which extended to the study of philosophy, medicine and astronomy (8). Nevertheless, his ultimate goal to prepare his scholars for the priesthood remained undiminished, and the New College curriculum was weighted in favour of theology. To ensure that it all went to plan, he installed his kinsman, Nicholas Wykeham, an experienced administrator, as the first head of New College (9), drawing mainly from the experiences of an earlier college, Merton, for its internal organisation. Although we have no detailed account of how successfully



Fig.2 Quadrangle, St. Catherine's College, Oxford

his intentions were realised, evaluation comes from the subsequent actions of two reliable witnesses: the first, one of Wykeham's early 'poor scholars', Henry Chichele (c.1362-1443) who went on to New College after Winchester; the second, William Waynflete (c.1400-1486), Headmaster of Winchester College for eleven years (10). Both seemed to have held their early experiences at the two colleges in such high esteem that they each created almost identical educational foundations when they subsequently became wealthy prelates.

Chichele became Archbishop of Canterbury, and founded All Souls College, Oxford and several schools. They were all 'to apply practical measures to increase learning', while for All Souls was reserved the aim: 'to perpetuate its founder's own public role of active and professional service' (11). He was a stoic, and set a fine example in being on active military service with Henry V on his French campaigns, frequently having to endure the hardships of the soldiers. And it is to the souls of those who died in the French campaigns that the college is dedicated.

Waynflete, after headmastering at Winchester College, entered King Henry VI's service to advise on the future of Eton College (12), then followed closely in Wykeham's footsteps to become Bishop of Winchester

and Chancellor of England, and founded another Oxford College, Magdalen, and, nearby, its school, again modelled on Wykeham's foundation. However, unlike Wykeham and Chichele, he did not build his college within the town walls, but just outside. Because more land was available there, he could be more expansive, and so incorporated a deer park within the walls, which still exists. His influence also extended to Cambridge. He persuaded the king to found the linked colleges of Eton and Kings, and he was 'given overall control of their implementation' (13), also becoming the first headmaster of the school and later, provost. He never forgot his origins, and following the now established tradition of wealthy 'former local boys' in later centuries, founded a grammar school, Magdalen College School*, at his birthplace, Wainfleet, in Lincolnshire. After 600 years it remains as another monument to him, and like many other of the early 'grammar schools', an enhancement to the cultural landscape.

It is apparent that in his lifetime Wykeham invested heavily in the education of young people; his motto in the vernacular for his two college foundations, perhaps reflecting his wish to achieve a wider appeal. (English as a language was becoming established at this period; Chaucer, a pioneer of the written language, succeeded Wykeham as Chancellor of England.) Although much of what he initiated has been adopted in school and college over the centuries, what seems never to have been repeated by those institutions is a motto in the vernacular. School and college mottos have remained rooted exclusively in Latin, the language of medieval scholars. I wonder why?

It is sadly ironic that at a period when such foundations of formal education were being laid to benefit a broader section of the population, there was

*The Wainfleet school is not to be confused with the Magdalen College School he founded in Oxford.

widespread dissatisfaction and disorder in the country, particularly in the south. This was a reaction to the series of restrictive government measures affecting most people in the years following the Black Death, culminating in the poll taxes of 1377-80 (14). At the demonstration of thousands of the discontented in Spitalfields under their leader, the truculent Wat Tyler, the young king, Richard II, with the connivance of his courtiers, and fearful of the consequences of granting them anything, conned them into dispersing. Persecution followed.

Postscript:

At a lecture in Winchester on 4th February 2010, Virginia Davis, author of the books on Wykeham and Waynflete referred to below, underlined how passionately Wykeham felt about the value of education in preparing a wider section of society for public service which might even involve high office as he had experienced, but without the support of an appropriate education.

Acknowledgement: to Mark Page in appreciation of his comments on an earlier draft.

References:

- Wykeham and Waynflete are usefully discussed in Mark Page's *The Medieval Bishops of Winchester: Estate, Archive and Administration*, Hampshire Papers 24, 2002.
1. James, T.B. *The Black Death in Hampshire* 1999, p.9.
 2. Davis, Virginia *William Wykeham* 2007, pp. 137-142.
 3. Davis, *ibid.* p.9.
 4. Hobhouse, Christopher *Oxford* 1952, pp. 2-3; DNB Vol. 60 2004, p.627.
 5. Moberley, G.H. *Life of William of Wykeham* 1887, p.189.
 6. VCH Vol. II 1911, p.282.
 7. Moberley, *ibid.* 'The Foundation Charter of Winchester College.'
 8. Moberley, *ibid.* p.204.
 9. DNB Vol. 60 2004, p.639.
 10. Adams H.C. *History of Winchester College and Commoners* 1878, pp. 63/4 and notes; Davis, Virginia *William Waynflete Bishop and Educationalist* 1993, DNB Vol.57 2004, p.781.
 11. DNB Vol. 11 2004, p.395.
 12. Davis, *ibid.* (*Waynflete*) p.4.
 13. DNB Vol.57 2004, p.783.
 14. James, *ibid.* p.11.

Tankerville Chamberlayne's Part in Eastleigh's Late Industrial Development.

The Chamberlayne family in the early 19th century owned extensive estates in south Hampshire, including the agricultural Eastleigh area, which then consisted of a few scattered farms; the land value, approximately 22/- (£1.10) an acre (fig.1). So, in the 1830s, the family was particularly gratified to discover that the London and Southampton Railway Company was planning to run its railway over a large tract of their land; so providing a golden opportunity for increasing their income. In 1838, the Company having bought the land, then built its line along the gently graded Itchen valley, followed in 1840 by two branch lines, creating an important junction near the only sizeable centre of population, Bishopstoke, after which the railway station there was named; only later being re-named Eastleigh. In a short time it became a minor trading centre with the emphasis on agricultural products, particularly cheese. In 1852, the County Cheese Market was established there (1 and fig. 1).

Thomas Chamberlayne, foreseeing the possibilities of increasing land values around the station, bought out the only other landowner in the area in 1861, thereby becoming the sole owner of all the land there. The family was then in a strong negotiating position when, in 1884, the railway company, after five years of indecision and postponements, finally decided to relocate its Battersea Railway Carriage works at Eastleigh (fig. 2). As the company intended to build only the workshops, it was left to private speculators to provide homes in the area for the hundreds of families moving from Battersea and Vauxhall. But, as the Chamberlayne Estates owned all the land around the station, close to the carriage works, they were again in the fortunate position of being able to determine the price of whatever building land was required.

Negotiations between Tankerville Chamberlayne, only surviving son of Thomas Chamberlayne, who died in 1876, and the leading private builder, Jonas



Fig. 1 The Eastleigh landscape in 1871, alongside the recently arrived railway

Nichols, are revealed in their correspondence. In a letter of April 1884 to Chamberlayne's solicitors, Nichols sets out proposals to purchase land close to Bishopstoke [Eastleigh] Station, but refers to indecisions on the part of the L&SWR Co. about the scale and timing of the proposed move, which are causing him 'to reserve judgement on the amount of land, but is willing to purchase 20 acres now'. He anticipates a purchase price of about £400 an acre. He also undertakes 'to lay out all roads and make all sewers, drains and other works necessary to a satisfactory standard' (2).



Fig. 2 Entrance to the Carriage Works, Bishopstoke Road, 1967. Photo: Courtesy Hampshire Record Office

Among the correspondence is a deed setting out an agreement with Nichols to purchase 400 acres of land close to the station. A memorandum of April 1886 from Tankerville to Nichols sets out the terms, which include the requirement to select 'not more than four different sites and lying within a radius of 1000 yards of the present enclosed piece of land...at present used as a cricket ground and village' (3).

Having purchased the land, Nichols, a former cabinet maker turned builder, drew up a grid-iron plan of the new town, with streets running from north to south, including Market Street and Tankerville Street (later High Street), and crossroads, of Blenheim and Grantham Roads cutting through them from east to west (4 and fig. 3). He then proceeded to lease sections of the planned streets to the many small builders also intent on making money but who lacked the capital necessary to purchase (5). Building progressed rapidly

to meet the demand of the London families needing homes. Although a new administrative body, Eastleigh Parish Council, had been set up in 1868, and the Southampton Borough Engineer had been appointed to ensure that the standards set out in the 1890 Housing Act were being met, it was clear that the close supervision demanded of the many building projects in operation, simply could not be met. By the 1890s many problems began to surface: poor sanitation, non-collection of refuse, flooding, inadequate street lighting, no fire hydrants, and other problems of poor planning and hasty building (6). These were highlighted by the editor of the local newspaper who attributed the cause to the fact that 'many of the houses in Eastleigh have been constructed by the Brothers Jerry' (7).

As rapid building continued into the 1900s to meet the needs of a population that had increased by 54% between 1891 and 1901, the town experienced an increasing scale of problems, which resulted in the appearance of damning reports in two national newspapers, the *Morning Leader* and the *Star*, on the 1st of September 1909. The *Leader's* headline ran: 'Landlord



Fig. 3 Grid-iron Eastleigh in 1909. (Great Eastleigh Farm is on the extreme left.)

Rapacity'; 'How Eastleigh is Bled by Landgrabbers'. A tirade followed:

'Eastleigh... a town created by the enterprise and industry of its workers, and then bled of large profits by persons whose only title to them had been their power to extract them.... provided beautiful opportunities for the land speculators and that these opportunities had been eagerly pursued . Like flies on jam, the land syndicates have swarmed down on little Eastleigh and richly have they feasted'.

'The main landlords were Willis Fleming in the south and Tankerville Chamberlayne in the north. When the L&SW Railway Company began to shift their works the bulk of the land hitherto had agricultural value. It was sold to syndicates for £450 an acre. The syndicates promptly proceeded to cut it up and resell it piecemeal for £900 an acre.'

'When the local council desired to purchase some of the available land for public purposes [a recreation ground]... they bought four acres from Mr. Chamberlayne for £3000. The Railway Company contributed £1000. A request for 37 acres for allotments...the owner asked £2000 an acre, which at the old agricultural value was 22/- (£1.10) an acre' (8). (The Council apparently resorted to a compulsory purchase order to acquire the land.)



Fig.4 The former Eastleigh Railway Working Men's Institute.



Fig. 5 An Eastleigh street and crossroads

Many of the above accusations were denied as untrue or exaggerated by Chamberlayne's solicitors, Messrs Desborough, in a letter to the *Star*, when they also pointed out that Mr Chamberlayne had given land for schools, a church and a churchyard (9).

The 'recreation ground' project (above) affords scope for an interesting comparison of evidence. According to the Council Minutes, when Mr. Chamberlayne was approached by a council representative, he offered a four acre field as a gift with the only proviso that the Council pay the legal fees and compensate the farmer who would lose access and grazing land. But, upon investigation the Council discovered that as the site was a former gravel pit it would need restoration before it could be used, and the total cost would be nearer three thousand pounds. Although the Railway Company offered £2000 towards the cost, the Council decided against the project; one member ruefully complaining that 'the Chamberlayne Estate had already made enough money extracting gravel from the site without expecting the ratepayers to fork out their hard earned money' (10).

What is also apparent is that the Railway Company was prepared to strongly support the acquisition of an amenity that would benefit their workers' families. The editor of the local paper was sufficiently impressed to observe: 'that the directors are encouraging a large section of their employees to be temperate and healthy.' This is further illustrated by several subsequent actions that underpinned the Company's desire to promote the health, social and spiritual wellbeing of their workers and their families. In 1891, the Company paid for extra accommodation in the newly built church, and in the same year provided a Public Hall and Working Men's Institute for their employees at a cost of £3000 (11 and fig.4).

The homes being built, which subsequently revealed many faults, nevertheless offered accommodation

superior to the terraces of northern industrial towns: 'a terraced cottage of three rooms upstairs, two downstairs plus a kitchen, but no bathroom and an outside toilet. The front doors for the most part opened on to a small front garden, while at the rear, sizeable plots were provided' (12 and fig. 5).

As for Tankerville Chamberlayne, his selling off and/or leasing of his lands for building, continued well into the 20th century. The archives reveal sales and leases of land for utilities such as the gasworks in North End Lane, (13) and a brewery (14) on the site of Great Eastleigh Farm.

The overall impact of this period of building on the local landscape, was summed up by a traveller, sightseeing in the early 1900s: 'Eastleigh may be left, for this is simply a collection of remarkably ugly houses that have sprung up around an important railway junction.' (15). Sixty years later, Pevsner observed: Eastleigh has plenty of public buildings, churches etc. of the period 1890 – 1910, but none are architecturally memorable. The Railway Institute of 1891 is in drab brick with neo-Jacobean details' (16 and fig. 4).

References:

1. Luffman, Bryan, *The Development of a Late Victorian Railway Town*, 1984, p. 2.
2. HRO 139M71/B14/1.
3. HRO 139M71/B14/1.
4. HRO 139M71/B14/4.
5. Luffman *ibid.* p.14.
6. Luffman *ibid.* p.15/16.
7. *Eastleigh Gazette and District Advertiser*, 4 June 1892.
8. HRO 139M71/B17/25 *Morning Leader*, London, 1 September 1909.
9. HRO 139M71/B17/25 *The Star*, London, 9 September 1909.
10. Luffman *ibid.* p.32.
11. Luffman *ibid.* p.18.
12. Luffman *ibid.* p.17.
13. HRO 139M71/B17/21.
14. HRO 139M71/B17/18.
15. Moutray Read, D.H. *Highways and Byeways in Hampshire*, 1908, p.27.
16. Pevsner, N. and Lloyd, D. *The Buildings of England: Hampshire and the Isle of Wight*, p.199.

A Drover's Legacy

Malcolm Walford

The search for droving routes across Hampshire has been the focus of a number of recent articles by George Watts and George Campbell (1). I believe that another nodal point has now been identified on the border of Hampshire and West Sussex, a mile or so north of Petersfield. It was the chance discovery of an advert on microfilm that prompted this research.

The landscape

The area concerned lies at the western extremity of the Lower Weald and, lying over Lower Greensand, is characterised by sandy heaths, hollow ways, and was, and still is, sparsely populated. A tongue of Wealden clay on which brick kilns were built in Harting Combe lies to the north west of the site.

The focus of my investigation was an isolated spot (SU 788.262) adjacent to the London/Portsmouth turnpike road. It was separated from the Hampshire village of Liss by Rake Common, from the Sussex village of Rogate by Rogate Common, and from the Sussex hamlet of Rake, by Rake hangar. To the south lay the course of the Western Rother, the market town of Petersfield and the tortuous route to Midhurst, another West Sussex market town. The location of the site is now known as Hill Brow. The original surveyors' drawings produced between 1808 and 1810 of the surrounding countryside show extensive heaths in Sussex between Hill Brow and Midhurst, Hill Brow and Haslemere and beyond to Farnham. In Hampshire, Woolmer Forest lay on the route to the market town of Alton and there were a number of thinly populated rural routes from Winchester. A feature of Woolmer Forest are 'hatches', being gates into the forest area (2). A Hatch Lane leads from Rake to the site of a hatch, just beyond which a squatter's cottage belonging to a member of the Knowles

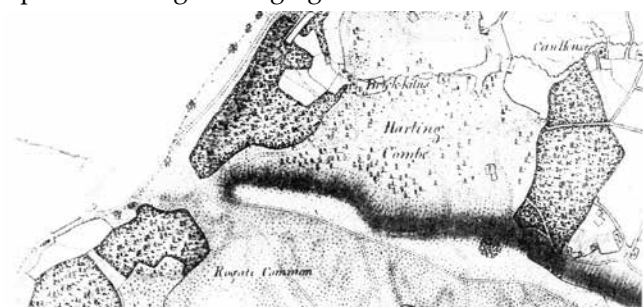

Fig.1 Early 19th c. tracks across Rogate Common.

family (see below) has been identified. The drawings for Sussex show a number of tracks across Rogate Common leading to the London turnpike (fig.1). But changes in this area were to take place ten years hence.

Enclosure

Rogate common and other manorial wastes in the manor of Wenham owned by William Buckle were enclosed. New enclosure roads were identified (fig.2), and the Petersfield Road (the London turnpike) was created sixty feet wide as it crossed the manor of Wenham. Osborn also acknowledged an ancient route from Durford Priory, on the river Rother, northwards via Pensford Lane to the manor of Durford and Rogate Common by creating a 'public right of road' 20 feet wide, which ran under the hedge of Durford Common.

It was the enclosure map that named the owner of the land, at what was then known as Shrubs Corner, later to become the site of a drovers' public house.

The owner

The Award recognised the sale of 27 acres by William Buckle to George Knowles (see fig.2).

Who was this buyer? Born in Rogate in 1778 and married by 1805, he apparently moved across the county border to Liss where his occupation was recorded by the curate as 'Ag. Lab.' (4). It is possible that he occupied a squatter's cottage in Woolmer Forest; the later Liss tithe map listed a William Knowles, a son and later executor of George, as having 3 roods 9 perches among the list of 50 various encroachments in 1843. However he was a thrifty 'agricultural labourer' with money enough to buy a substantial plot of land. Subsequent research using census information recorded his occupation, in 1851, as a cattle drover. As Scott wrote in *The Two Drovers*, these men were highly paid for 'their prudence, vigilance and honesty', and their skill in getting their cattle to market in good condition and obtaining the best price (5).

No records exist in local archives as to when he actually took possession of this area of common. He and his family would have worked very hard to clear and fence the land. Indeed this was a family who needed and possessed all the qualities of pioneers. His illiteracy (he was unable to sign his will) did not prevent him achieving a good living, helped no doubt by his friendship with the Mellersh family, yeoman farmers in Rogate, who probably gave him a lot of work (6) and by the proximity of a number of markets and fairs on both sides of the county border. Watts identified fairs and markets in Hampshire in 1831 (7). *The Hampshire Telegraph* regularly listed dates of forthcoming fairs in Hampshire and neighbouring counties; for example on 28.9.1818 it listed 21 fairs in Sussex in October, which included Midhurst, South Harting, and Chichester.

The ground purchased was uncleared waste. Brandon (8) states that clearing a site on common waste was a laborious task, the ease and speed of which would have depended on three factors – the nature of the vegetation, whether tree scrub or bush cover; the nature of the soil; and the slope of the land which affected drainage, cultivation and the amount of sunshine received. Controlled burning of felled and cut-over patches, known as burn-beating, would have provided valuable ash for manuring successive crops. Once the farm and accommodation for passing droves had been established, supplies of manure would have been plentiful. The site slopes gently southwards and sits on a ridge that slopes steeply to the west towards Liss and to the north-east to Harting Combe. As the enclosure map shows, the new Rogate road divided the land holding, and George decided to put up a dwelling on the north side but, significantly, faced it not to the turnpike but to the new road. He knew the routes used by the drovers for he, and, I suggest, his father whom he most probably followed into the occupation, had used them himself.

Opposite the Rogate road, a track (9) into Hampshire across South Common, part of Rake

Common, formed a cross roads with the main road to Petersfield and London.

More changes were in the wind

Two beneficial events occurred around the time that George acquired the land. An advert appeared in *The Hampshire Telegraph* announcing that a cattle fair would held on Saturday 7 October 1820 on Petersfield Heath where the principal dealers " from Devonshire and the different counties in Wales would attend ". This announcement dated 8 September, location Petersfield, was void of sponsors' names. It has been suggested that farmers with rights of common on the Heath may have



Fig.2 Enclosures and enclosure roads in the Rogate Common area.

been behind this initiative but someone in authority, now anonymous, must have contacted these dealers in the west. This event was such a success that another fair, which this time included sheep, took place on 6 October 1821 when 2,000 cattle appeared on the Heath and 5,000 sheep in an adjoining field (10).

The study area was already bracketed by toll-gates. The Portsmouth to London turnpike, the north / south route, had two toll-gates just north of Petersfield, one at Sheet Bridge and the other at Rake.

In 1825 an east/west turnpike road was opened just south of Rogate Common. It ran from Midhurst and linked with the Portsmouth to London turnpike between the 52nd and 53rd milestones, just north of Sheet bridge, which had a toll house near Sheet Common (11). This provided another reason for using the route through George's recently acquired land to Midhurst via lanes that ran parallel to the turnpike, as well as the use of the ancient route bordering Durford Common.

The drover's plans bear fruit

The first record of permanent buildings on George's land holding appears in the Poor Rate Book for Rogate. Whilst the first entries in the book for 1824 make no mention of George Knowles, the next entries for 1827 show that he owned and occupied a house and garden with a rateable value of £4.10s. In 1842 he is shown as occupying and owning " Shrubs Farm ", rated at £15.15.6d.

He still had his cottage, later recorded as " Kiln Cottage ", and garden.

Some time after he had built his farmhouse he started to brew beer for sale, as was common practice with many farms and small cottages. He probably obtained a licence from the Excise under the 1830 Beer Act (12) but these records have not survived for this area, and trade directories are not early enough

for this remote location. However the 1841 census recorded him as " a publican ", aged 63, living on what the enumerator described as " Rake Common " with his wife, two daughters and two servants and a ten year old boy. James, one of his sons, was also living at 'Rake Common' with his wife and six children, almost certainly in the aforementioned cottage and garden.

Further information as to the development of the site from the early 1820s is provided by the 1843 Tithe Map of Rogate. For example: Barnfield, 6 acres, large enough for overnight livestock accommodation (a stance); Slip Hop Field, a small plot of just under an acre, possibly provided ingredients for his brewery.

I was very curious about the supply of water both to the property and livestock. Further investigation among the maps in the West Sussex Record Office produced one (fig.3) which showed a pond, in Hampshire, just across the turnpike road from the pub but which was included in the map of Rogate parish. This pond also appears beside what used to be called 'Drovers Road' and appears on the 25inch OS map dated 1873, but has now completely disappeared. The current landlords of the 'Jolly Drover' showed me the site of a 120 ft well that has been capped and covered by a recent extension of the building.

George's wife, Hannah, died in 1844, and it was around this time that he decided that the farm and buildings needed replacing because, on 16 May 1846, there appeared an advert in *The Hampshire Telegraph*, an event which initiated my original research.

To be sold by public auction on the premises - All that newly erected Public House called the Jolly Drover ... with a small brewery attached, with 29 acres (more or less) of arable land, with a barn, two stables, two cart-houses, cow-pen, piggeries and farm-yard; there is also a new Lime Kiln erected on the land.

He did not manage to sell it. The Rogate Poor Rate Book shows that on 14 October 1846, the property known as " Shrubs " was owned by George but occupied by his son James. This did not work out because in January 1847 George is recorded as both owning and occupying " Shrubs " and James was once more occupying the cottage.

The final years

George, now 69, was finally able to relinquish the day-to-day running of the " Jolly Drover ", when John Sands Read took up the tenancy sometime before October 1847. Read was still there on 30 March 1851 Census when he was recorded as a 'licensed victualler', living with his wife, four children and Edward Knowles, one of George's grandsons who is described as an " Ag. Lab. "

George now aged 73, gave his occupation as 'Cattle Drover'. He was living with his youngest daughter, Jemima, aged 32, recorded as 'House Keeper' which description was deleted but aptly tells of her role (13). As if to indicate that this area was still isolated, the enumerator wrote at the bottom of the page " End of scattered houses on Rogate Common. "

In May of the following year, George decided to put his affairs in order and made his will. His friend William Mellersh, a yeoman farmer, now living in Hampshire at Hawkley, was made an executor. On his death all his property was to be sold and divided among his children, which included 'my reputed son,

William Banks'; he was an honourable man. He lived for a few more years, perhaps doing the occasional short drove, before he died, aged 79, on 17 January 1857. His enterprise had been unaffected by the coming of the railway, whose single line did not reach Petersfield until 1858. Droving continued in the family tradition because Edward, one of his sons, had followed him into



Fig. 3 Mid 19th c. estate map showing 'The Jolly Drover' and pond. [Courtesy West Sussex Record Office]

the droving trade, according to his marriage records; he had married a young widow from Frensham, on the route between Hill Brow and Alton market.

His legacy

George Knowles had chosen a good site to settle down with his family and create his future business. Unlike the 'Bangor Inn', built by a landowner in the 18th century but abandoned (14), the 'Jolly Drover', built by a drover, thrived.

Lack of space permits just a very brief history of the pub after 1857. The Rogate Poor Rate Book shows that the 'Jolly Drover' had been purchased by R. Crafts. He was a Petersfield businessman who owned 'The Steam Brewery' and three hotels in the town. The pub was eventually owned by W & R Luker of Southend, then, Strongs of Romsey. According to Harper, whose book was published in 1895, 'another roadside inn, the Jolly Drovers (sic) planted 'mid capacious barns and roomy outhouses, at the angle of another country lane, leading to Rogate. A modern front had recently been added' (fig. 4).

Today there is no evidence of droving, apart from the name. The fields opposite were sold off and a late Victorian mansion, Clayton Court, built some time earlier than 1881. The land around the public house was also sold, most recently for a development of bungalows appropriately named 'Knowles Meadow'. George's original cottage still



Fig. 4 The Jolly Drover c.1900

stands and is an occupied private house.

Two outbuildings, recently converted to bedrooms, still have the original sandstone outer walls with ironstone galletting, a not uncommon feature in this area.

Today the "Jolly Drover", with its own website, now sits within the South Downs National Park and is still offering food and accommodation to passing travellers.

Acknowledgements

I would like to thank Frances Lansley and Diane Ladlow at West Sussex Record Office, Jane Philpot at the Hampshire Record Office, John Pile, Dr P. Jennings, my son Mark, and Barry and Anne Coe, landlords of the "Jolly Drover" for their help and advice.

Maps are reproduced by kind permission of the County Archivist, West Sussex Record Office.

References

- Brandon P - *The Kent & Sussex Weald* (2003)
Wooldridge S W & Goldring F - *The Weald* (1953)
1. HFC Newsletters Nos. 42, 46, 47 & 57.
 2. John Pile - e-mail communication.
 3. WSRO. Add Mss 5178.
 4. Liss Register of baptisms.
 5. The Oxford Book of Scottish Short Stories p.31
 6. William Mellersh was one of the Surveyors of Highways for Rogate parish when the common was enclosed. William Mellersh, a yeoman farmer, was described as "his friend" when George Knowles appointed him one of his executors.
 7. Watts D G *HFC Newsletter* 25 (1996)
 8. *The Kent & Sussex Weald* - pages 83 and 84.
 9. This was known as "Drovers Road". See Mrs Bashford page 28.
 10. *Hampshire Telegraph* 2.10.1820 p.1 and 8.10.1821 p.4.
 11. Geo IV Cap X1 - Turnpike road from Midhurst to London & Portsmouth turnpike.
 12. Dr. P Jennings, University of Bradford - e-mail communication.
 13. Jemima did not remain a spinster but married in February 1859, after her father's death.
 14. Watts D G. The Ox drove and the Bangor Inn. *HFC Newsletter* 42(2004).



Programme of Events

September - December 2012

- 9th Sept Sunday - Landscape Section
Visit to Overton – medieval and post-medieval buildings. (This is a repeat visit.)
- 22nd Sept Saturday - Historic Buildings Section
Visit to Mottisfont Abbey and church. (This is a repeat visit.)
- 26th Sept Wednesday - Historic Buildings Section
AGM, followed by Richard Harris (former Director of the Weald and Downland Museum and author of “Discovering Timber Framed Buildings”) on “How to Take a House Down”. Peter Symonds’ College.
- 6th Oct Saturday - Local History Section
AGM & Visit to Lyndhurst
- 27th Oct Saturday - Landscape Section
AGM & Conference: “Waterways in the Landscape” to be held at the Hampshire Record Office.
- 24th Nov Saturday - Archaeology Section
AGM & Conference: “The Changing Face of Kingship in Early Medieval England” to be held at Peter Symonds’ College